

BILLINGSHURST
MEETING HOUSE
REGISTERS



The Meeting House
Billingshurst
Sussex

THE
GENERAL BAPTIST MEETING HOUSE
now known as
THE FREE CHRISTIAN CHURCH (UNITARIAN)
BILLINGSHURST

COMPOSITE REGISTER OF DEATHS
AND
MONUMENTAL INSCRIPTIONS



www.unitarian.org.uk/docs

Edited by
Leonard J Maguire
October 1985

Edited and
Published Privately
by
Leonard J Maguire
for the
General Baptist Assembly
14 Gordon Square
London WC1H OAG
October 1985

CONTENTS

Introduction	page 3
Composite Register of Deaths	7
Monumental Inscriptions	25
Plan of the Burial Ground	51
Index to Persons	57

INTRODUCTION

The purpose of this work is to place before the public such details as have come down to us of the people who were buried, or for whom memorials were erected, in the General Baptist Meeting House Burial Ground at Billingshurst. It is hoped that the work may prove of value to those studying the genealogies of their families or local history.

The Meeting House was built in 1754. Burials began at about the same time. The people, as an organised community, had been in existence for some hundred years at that time. They had been meeting for worship in small groups in farm houses or barns converted for use as meeting places since they emerged from obscurity during the civil war.

The earliest of the purpose built meeting houses in West Sussex was that at Horsham, erected in 1721. It served as a central meeting place for the existing groups of people scattered over a wide area, including Billingshurst, though, due to the difficulties of travel, they continued to meet separately for many years after that date. Even after the meeting house was built at Billingshurst, the people there continued to regard themselves as a part of the Horsham Church.

As the 18th century closed there began a gradual movement within the General Baptist community towards the Unitarian standpoint in religious matters and, a few years later, a gradual abandonment of the practice of believers baptism. The story of this development can be found elsewhere. It is mentioned here only to explain the change in the name of the Church from General Baptist to Free Christian or Unitarian and the building from Meeting House to Chapel.

The erection of the Meeting House at Horsham stimulated the creation of a Register of Births for the use of the General Baptist community as a whole and in which the births of many of the Billingshurst people were entered. This Register had become necessary due to the reluctance of some clergy to enter births in Parish Registers where the parents declined to submit their children to the traditional rite of infant baptism. The Horsham Births Register continued to be used till the creation of the General Register in 1837.

REGISTER OF DEATHS

No Deaths Register was kept either by Billingshurst or Horsham in the early days. Such records as were kept were somewhat incidental. At Horsham the gravedigger kept a list of burials primarily as a record of burial fees received. At Billingshurst most of the early funeral services were conducted by William Evershed, some details of which he entered into a personal notebook.

In time both Churches began to keep a formal Register of Burials though, when these registers were required to be deposited in London under the General Registration Act of 1837, the subsequent recording of burials became somewhat spasmodic.

For these reasons it was concluded that the objectives of this work would best be served by constructing a Composite List of Deaths from such records as were available and to add to this a transcription of the Monumental Inscriptions.

SOURCE MATERIALS

Those used in preparing this work were:

a) The notebook of William Evershed (1717-1799). He was one of the outstanding Preachers of his age and a tireless visitor to the Churches of Sussex and further afield. He was, with William Turner, largely responsible for the erection of the Meeting House at Billingshurst. In his notebook he entered the date and sermon texts of all the funerals which he conducted between 1744 and 1782. These included 57 at Billingshurst, some before the Meeting House was built. (Facsimile in Dr Williams's Library, WSRO &c).

b) The Chapel Register was begun in 1821 and contains entries up to 1837 after which it was deposited in the General Register Office. (Public Record Office Chancery Lane - MS No RG4 2939)

c) Frank Evershed of Kenley (1852-1918) toured the country between 1875 and 1892 collecting family historical data and entered this into 22 notebooks of which eight have come down to us. These contain some details of births and deaths and some monumental inscriptions not found elsewhere.

d) Arnold Ridley Bax FSA (1854-1918) left a volume in which he entered details of some Monumental Inscriptions seen by him in 1907. (Sussex Archaeological Society Barbican Lewes Ref: 929.5/MI(W)).

e) Visual inspection of the surviving gravestones carried out by the then Church Secretary and his son some 40 years ago (the latter being the present Chapel Secretary) and more recently by others.

Where the notes of Frank Evershed conflict with those of Ridley Bax, the former are assumed to be the more authentic unless the inscriptions concerned are still legible and indicate otherwise. Recent genealogical study by others indicate that some minor errors occurred when the scribes of the time made the original register entries. The serious genealogical student is therefore commended to cross check with such other sources which may be found where dates or ages as here recorded appear suspect.

ACKNOWLEDGEMENT

The Editor acknowledges with gratitude the work of the present Chapel Secretary, John Dendy Evershed, who prepared the manuscript draft of the composite register of deaths, and who has made his source materials available during the preparation of the work. Also of his distant kinsman, Peter Bernard Evershed, who prepared the facsimilie reproduction of the William Evershed notebook and has given much other help and encouragement.

COMPOSITE
REGISTER
OF
DEATHS

NOTES ON THE REGISTER

1. The dates here given refer to the date of death except where indicated 'bu' where only the date of burial is known
2. In some cases dates given on the Monumental Inscriptions conflict with the dates in the Register of Deaths
3. Certain abbreviations have been used viz:

WE57 &c the corresponding entry No 57 in William Evershed's record

FE information from Frank Evershed

RB information from A Ridley Bax

D1 entry No 1 in this register

G13A entry in the Register of Monumental Inscriptions and referring to row 13

DEATHS

D	Details	Date	Ae	G
1	w of Richard WHALES	WE57 bu	24 12 1755	
2	w of William BURCHILL	WE60 bu	3 3 1756	
3	c of John BAKER	WE67 bu	26 6 1757	
4	c of John BENNET	WE77 bu	8 10 1758	
5	c of John WHEELER	WE78 bu	22 10 1758	
6	Richard WHALES an ancient labouring man	WE82 bu	8 6 1759	
7	widow of John SENDAL	WE83 bu	11 6 1759	
8	Susan DEAN w of John Shipley (FE Ae 73)		26 4 1760	63 13A
9	Walter KNIGHT	WE89 bu	20 6 1760	
10	w of William POTTER	WE90 bu	19 7 1760	
11	c of John DENDY	WE95 bu	1 9 1761	
12	Samuel PUTTOCK	WE98 bu	31 3 1762	
13	Giles BROWNE bu in Parish Churchyard	WE103 bu	12 9 1762	
14	w of William GREENFIELD late of Prats	WE106 bu	9 1 1763	
15	Thomas EVERSHERD	WE117 bu	24 4 1765	86 14G
16	c of John BAX	WE118 bu	5 5 1765	
17	c of Richard EVERSHERD of Pallingham	WE119 bu	23 8 1765	
18	William BAKER s of Reuben & Jane (FE states 18 Feb)	WE123 bu	10 2 1766	1y 13L 5m
19	Elizabeth EVERSHERD widow of D15	WE146 bu	3 1 1768	82 14G
20	John STOVEL	WE147 bu	10 1 1768	
21	Thomas POTOCK	WE153 bu	21 9 1768	
22	Joseph EVANS	WE159 bu	27 4 1769	
23	c of Richard EVERSHERD	WE161 bu	14 1 1770	
24	c of James STEARS	WE168 bu	5 1771	
25	c of John EVERSHERD	WE169 bu	31 5 1771	
26	Adam BAKER	WE172 bu	15 12 1771	
27	widow TURNER of Hadfoldsean	WE174 bu	3 1772	
28	c of Arthur BAKER	WE182 bu	17 1 1773	
29	c of John EVERSHERD	WE183 bu	10 2 1773	
30	Simon BAKER	WE187 bu	6 11 1773	
31	c of James STEERE	WE190 bu	27 3 1774	
32	William HASLEDEN	WE191 bu	24 4 1774	
33	William POTTER of Itchingfield	WE193 bu	28 5 1774	
34	c of James STEERE	WE194 bu	3 7 1774	
35	Mary EVERSHERD w of Richard D55	WE197	28 11 1774	48 14E

DEATHS

D	Details	Date	Ae	G
36	Elizabeth CHALLEN Petworth d of D55 & 35 WE199	30 3 1775	22	14D
37	c of James STEAR WE205 bu	5 11 1775		
38	w of John BENNET WE206 bu	21 12 1775		
39	c of John KNIGHT WE212 bu	7 9 1777		
40	widow of Thomas PUTTOCK WE214 bu	10 11 1777		
41	Arthur BAKER WE216 bu	20 11 1777		
43	w of Lander BOOKER Rudgwick WE217 bu	13 12 1777		
44	John CHARMAN Chiltington WE220 bu	1 2 1778		
45	c of James STEER WE223 bu	26 4 1778		
46	Sarah MUTTON Thakham w of Rich D101 WE225	4 5 1778	42	
47	widow TOWSE B'hst WE226 bu	21 6 1778		
48	John EVERSHEDE Jr Rushett Bramley Sy WE229	4 3 1779	25	14H
49	Arthur BAKER h of D85 (entry error ? see 41)	17 11 1779	42	12C
50	James BAKER s of D49 & 84 died in infancy			
51	Elizabeth BAKER do do			
52	widow BAKER WE238 bu	28 5 1780		
53	Joseph POTTER of Jefferys WE243	15 9 1781	75	11G
54	widow EVANS WE256 bu	1 12 1782		
55	Richard EVERSHEDE	7 2 1784	62	14E
56	Sarah EVERSHEDE d of D211 & 83 Ae 2 years 11 m	24 1 1785		13E
57	John BOURN	3 8 1785	80	13K
58	Ann KNIGHT d of D96 & 199 Ae 10 weeks	5 2 1788		11H
59	Elizabeth POTTER w of D53	20 6 1788	71	11G
60	John BROWNE Pulborough d of smallpox	15 10 1788	29	10C
61	Isaac LUDDY s of William & Rachael Ae 1y 6m	9 12 1789		12G
62	Thomas EVERSHEDE of 'Penfolds'	appx 1790		
63	Mary BOURN w of D57	28 2 1790	79	13K
64	Mary EVERSHEDE first w of D146	4 11 1790	28	15K
65	Jesse BAKER (see D70)	appx 1791	91	11F
66	Elizabeth EVERSHEDE w of D93	13 2 1792	66	14J
67	Hannah BOURN w of D91	2 1793	72	12M
68	William POTTER	28 3 1793	29	15C
69	Sarah BAKER w of Adam	15 11 1795	33	12F
70	Jesse BAKER s of D49 & 85	22 4 1796	32	12A
71	Ann JEFFERY d of D143 & 145	1 8 1796	12	25A
72	Thomas TOWSE of Andrews Hill	16 11 1796	75	12E

DEATHS

D	Details	Date	Ae	G
73	Mary EVERSHEDE d of D211 & 83	9 5 1797	5	13E
74	George EVERSHEDE s of do	24 4 1798	4 $\frac{1}{2}$	13E
75	Elizabeth EVERSHEDE d of do	21 6 1798	17	13E
76	Sarah BAKER	5 4 1799	29	12A
77	Richard EVERSHEDE s of D254 & 160 Ae 6 days	19 8 1799		9E
78	William EVERSHEDE '44 years Pastor of B'hst'	6 7 1799	82	20E
79	Mary EVERSHEDE w of D78	5 9 1799	82	20E
80	Elizabeth EVERSHEDE d of D219 & 191	17 7 1800	2 $\frac{1}{2}$	9K
81	Joseph POTTER	15 6 1801	45	9L
82	Jane EVERSHEDE first w of D211	24 6 1801	41	14B
83	Mary TOWSE widow of Thomas	12 11 1801	59	12D
84	Alice BAKER w of D49	3 4 1803	65	12C
85	John Evershed HAYWARD s of D320	26 10 1803	3	9C
86	Mary SAYERS w of John	15 1 1804	89	15Q
87	Elizabeth ELLIS w of D89	13 2 1804	72	15A
88	Martha HARD w of John	18 6 1804	50	10A
89	John ELLIS	4 7 1804	83	15A
90	Thomas GREENFIELD s of D113 (from RB)	3 9 1804	17	20D
91	Richard BOURN	1807	87	12M
92	Fanny TOWSE	13 4 1807	24	
93	John EVERSHEDE of Rushwood Common	7 1 1807	86	14J
94	Louisa Caroline JEFFERY w of D110	3 1 1808	24	24B
95	Mattie COOTER of Pulborough d of John & Eliz Ae 11 years 10 months	19 4 1808		11D
96	James KNIGHT	4 11 1808		11H
97	James COOTER of Pulborough s of John & Eliz Ae 4 years 10 months	23 11 1808		11C
98	Ann HAYWARD d of D320 & 222	18 1 1809	4	9C
99	John EVERSHEDE	30 7 1809	64	20G
100	Jane TOWSE w of D168	21 2 1810	37	11A
101	Richard MUTTON	8 12 1810	80	13J
102	Mary EVERSHEDE d of D103 & 125	14 12 1810	17	15N
103	Richard EVERSHEDE	12 4 1811	54	15P
104	Selina EVERSHEDE d of D167 & 201	10 7 1811	4	10E
105	James KNIGHT	16 11 1811	81	11L

DEATHS

D	Details	Date	Ae	G
106	Thomas MUTTON	18 4 1812	42	13M
107	Mary EVERSHEd d of D146 & 64	30 11 1813	27	15J
108	Elizabeth KNIGHT w of D259	8 7 1814	32	10D
109	Mary Ann HAYWARD d of D320 & 222	30 5 1815	5	9C
110	John JEFFERY	14 6 1815	35	24B
111	Hannah TROWER w of D114	22 6 1815	68	12P
112	Elizabeth BAKER w of Simon	19 3 1816		13C
113	Mary GREENFIELD nee Evershed w of Arthur	21 12 1816	69	20F
114	John TROWER	10 4 1817	70	12P
115	Elizabeth JEFFERY d of D143 & 145	20 5 1817	28	25B
116	Mary KNIGHT w of D105	11 8 1818		11L
117	—			
118	Richard HAYWARD s of D320 & 222	14 4 1819	13	9C
119	Mary BAKER	13 6 1819	17	13D
120	Sarah EVERSHEd d of D160 & 254	24 12 1819	7	9F
121	Jane JEFFERY d of D143 & 145	25 2 1820	33	25B
122	Thomas Letter TAYLOR Minister	9 9 1820	26	20B
123	George EVERSHEd died young s of D358 & 311	1821		
124	Ann EVERSHEd w of D202	30 5 1821	75	14C
125	Mary EVERSHEd of Ridinghurst w of D103	26 11 1821	66	15P
127	Sarah BAKER of B'hst w of John	27 11 1821	38	
128	Matthew Baker infant c of John & Sarah	4 12 1821		
129	Mark BAKER do	8 12 1821		
130	Matthew CAFFYN of B'hst s of Matthew & Johanna bu	14 3 1822	7m	7A
131	Mary MUTTON Heath Common Thakenham w of D106	15 4 1822	50	13M
132	Ann GEORGE of Storrington w of John	24 4 1822	60	
133	Reginald PUTTOCK of B'hst s of James & Hannah	13 5 1822	15w	
134	Hannah POTTER of B'hst w of James	26 5 1822	35	
135	Hannah HAWKINS widow of B'hst	3 10 1822	65	
136	Hannah POTTER 1st w of D349 mother of D175,186 &c	1822		5S
137	Giles EVERSHEd of Shalford formerly Rushett	11 10 1822	64	14N
138	Hannah KNIGHT of Pulborough d of John & Jane	5 12 1822	17	
139	Elizabeth NASH of West Chiltington w of Edward	26 12 1822	33	
140	Sarah BOURN of B'hst spinster	19 2 1823	73	
141	Hannah PUTTOCK of B'hst w of James	11 7 1823	33	
142	Cassandra PUTTOCK of B'hst d of James & Hannah	25 9 1823	2½m	

DEATHS

D	Details	Date	Ae	G
143	John JEFFERY of B'hst	28 8 1824	74	24C
144	Rebecca EVERSHEd d of D219 & 191	22 9 1824	25	8C
145	Ann JEFFERY w of D143	3 11 1824	73	24C
146	William EVERSHEd of Tedfold B'hst (PRO 23rd)	22 12 1824	70	15H
147	Elizabeth EVERSHEd d of D311 & 358 (PRO)	5 1 1826	7	
148	Charlotte PUTTOCK d of Thos D207 & Ann	24 5 1825	13	23?
149	John GEORGE of Storrington	2 9 1825	62	
150	E ELLIS of Rudgwick relict of	1 10 1825	76	
151	Sampson BAKER s of John & Sarah	24 11 1825	9	
152	Mary Ann TAYLOR d of F & Catherine	6 12 1825	6	
153	Frederick BAKER of B'hst s of James & Mary	14 12 1825	2	
154	Martha BAKER of B'hst d of Arthur & Elizth	7 1 1826	21	
155	Sarah KNIGHT of B'hst w of Philip	21 1 1826	82	
156	Ann POPE of Shere Sy w of Joseph	22 1 1826	60	
157	Elizabeth KNIGHT of Washington w of Joseph	25 1 1826	80	
158	Alfred POTTER of B'hst s of James & Elizth	6 2 1826	1w	
159	Jane EVANS d of William & Lydia	13 4 1826	3	
160	Elizabeth EVERSHEd w of D254	2 7 1826	54	9D
161	Mary CLARKE of Pulborough w of John	12 9 1826	64	
162	Ann EVERSHEd w of John D99	23 9 1826	64	20H
163	Emily KNIGHT d of D259 & 108	15 10 1826	20	11M
164	John WORSFOLD (Worssell on MI)	29 11 1826	29	7M
165	John CRAGG of B'hst	25 2 1827	25	
166	Adam BAKER	21 3 1827	80	12H
167	Thomas EVERSHEd	9 11 1827	71	20C
168	Thomas TOWSE of Andrews Hill B'hst	16 10 1828	60	11A
169	Richard JUPP of B'hst	22 10 1828	82	15D
170	Susanna Jupp w of Richard	16 11 1828	80	15D
171	Frank EVERSHEd of Albury s of John	16 10 1829	2½	14M
172	Rebecca PRICE w of D281	27 6 1830	39	24D
173	Jane CAFFIN d of Matthew & Johanna	2 12 1829	13	7A
174	Jane KENSETT d of Peter & Susannah	12 1 1831	7	7H
175	Harriet POTTER d of D136 & 349	5 6 1831	15	5S
176	Mary HAWKINS of B'hst d of James bu	18 10 1831		
177	Edward EVERSHEd s of D160 & 254	3 11 1831	22	9G
178	Eunice BAKER w of D304 d of D167 & 201	17 12 1831	28	7P

DEATHS

D	Details	Date	Ae	G
179	Henrietta EVERSLED 1st w of D310	20 4 1832	41	15F
180	Horatio PUTTOCK of B'hst	bu 6 12 1833		
181	Caroline TOWSE of Five Oaks	bu 24 10 1833		
182	Ellen KENSETT of B'hst d of Peter & Susannah (same child as recorded died 1.12 1833?)	23 11 1833	5 $\frac{1}{2}$	7G
183	William EVERSLED of Newbridge s of D254 & 160	5 2 1834	26	9H
184	Leonard EVERSLED s of D307 & 350	30 6 1834	2	7L
185	Catherine TAYLOR w of D122	17 7 1834	41	20B
186	Mary POTTER d of D136 & 349	5 11 1834	25	5S
187	James HAWKINS of B'hst	bu 27 6 1835		
188	Ann POTTER d of D136 & 349	27 12 1835	13	5S
189	Jane POTTER of Artington w of D81	14 3 1836	78	9L
190	Eliza POTTER of Jeffries d of D136 & 349	15 9 1836	18	5S
191	Elizabeth EVERSLED w of D219	8 2 1837	67	9J
192	William TOWSE h of D274	8 7 1837	41	20A
193	Edwin BAKER s of D336 & 228 Ae 2 years & 2 mos	23 8 1837		6S
194	Thomas TURNER of Palmers	6 9 1837	67	6A
195	James TROWER	14 10 1837	53	4G
196	James BAKER	28 4 1838	44	6P
197	William CARTER	11 2 1839	54	6J
198	Mary TURNER w of D194	7 10 1839	69	6A
199	Ann KNIGHT w of D96	3 12 1839	83	11H
200	Sarah MITCHELMORE	19 1 1840	77	2C
201	Mary EVERSLED w of D167	30 3 1840	77	20C
202	John EVERSLED of 'Streele'	13 4 1840	90	14C
203	Alfred EVERSLED s of D290 & 352	24 8 1840	16	6N
204	Zeruiah ELPHICK nee Evershed d of D167 & 201			-
205	Thomas PUTTOCK	24 4 ?	51	22C
206	Eliza PUTTOCK w of D205	1 ?	80	22C
207	Thomas PUTTOCK	-		23D
208	Edward PUTTOCK s of D207	-		23D
209	Elizabeth PUTTOCK d of D207	-		23D
210	Mary BAKER of Aldring-Bourne w of D196	4 11 1840	43	6P
211	Edward EVERSLED of Worthing	4 2 1841	86	14B
212	Ann STEER of B'hst	bu 27 7 1841		
213	James EVERSLED of B'hst	bu 8 2 1842		

DEATHS

D	Details	Date	Ae	G
214	Emily STEER of B'hst	bu 14 4 1842		-
215	Sarah EVERSLED of Little Dawks 2nd w of D146	29 7 1842	88	15H
216	John EVERSLED of B'hst	bu 29 1 1843		14P
217	Sophia Sale EVERSLED of Arundel d of D290 & 352	1 5 1843	17	6N
218	John TURNER of 'Rosier'	1 7 1843	84	6B
219	Thomas EVERSLED of Abinger	4 7 1843	78	9J
220	Ann BAKER of Cobithall d of D228 & 336	9 3 1844	28	6R
221	Charlotte CRAGG of Padbrook	-		
222	Ann HAYWARD of Petworth w of D320	bu 10 7 1844	66	-
223	Ann EVERSLED of Tedfold d of D310 & 179	30 9 1844	22	16F
224	William Cragg of Padbrook			
225	Elizabeth EVERSLED Meadow w of D137	26 10 1844	86	14N
226	Arthur BAKER of B'hst h of D252	8 12 1844	77	13B
227	Edwin Pelley TOWSE of Five Oaks	20 4 1845		-
228	Ann BAKER w of D336	30 7 1845	50	6Q
229	Fanny KENSETT of Brighton d of Peter & Susannah	12 9 1845	10	7J
230	John EVERSLED of B'hst	bu 25 12 1845		-
231	William TURNER of 'Rosier'	26 12 1845	84	6C
232	Ann STREATER w of D238	26 12 1845	62	21B
233	John STREATER of Lancing	bu 2 1 1846		- 21B
234	Elizabeth COOTER of Pulborough w of D258	19 3 1846	77	5W
235	John BAKER of B'hst	7 12 1846		-
236	Jane TURNER of 'Dunkins'	19 3 1847		-
237	William BROWNE of Shipley	30 3 1847	85	10B
238	John STREATER of Lancing	22 4 1847	64	21B
239	Caroline TROWER	30 4 1847	1	4F
240	Jane EVERSLED widow of John, Drover	16 8 1847	78	-
241	John WELLS of 'Hole Farm'	25 8 1847		-
242	Ann TURNER spinster of 'Rosier'	13 10 1847	82	6D
243	George Thomas EVERSLED of Great House s of D307/350	17 12 1847	4	7L
244	Caleb TROWER of Reigate	17 12 1847		-
245	James TROWER of Rowfold	1 2 1848	73	12L
246	Jane KNIGHT of B'hst w of Stephen	13 2 1848		11J
247	Daniel TOWSE of Five Oaks	18 2 1848		-
248	Jane TURNER of Duncans d of D194 & 198	20 3 1848	40	6E

DEATHS

D	Details	Date	Ae	G
249	Jas TOWSE infant son of Luke	5 1848	-	
250	Thomas BUCKMAN of Eaton	4 8 1848	-	
251	Sarah DENMAN of Shoreham	3 3 1849	-	
252	Elizabeth BAKER of East Lane B'hst w of D226	10 4 1850	80	13B
253	Elizabeth TROWER of Rowfold d of Tho Ae 17 days	9 5 1850	-	
254	Richard EVERSHEED Newbridge	3 9 1850	76	9D
255	Alfred CHINNOCK of Horsham late Portsmouth s D266	28 9 1850	16	14L
256	Alfred Huteson TOWSE of Five Oaks s of Alfred	8 12 1850	31w	-
257	Clara TROWER of Reigate d of John Trower	17 4 1851	9m	-
258	John COOTER of Pulborough	9 12 1852	84	5W
259	Stephen KNIGHT of Billingshurst Street	6 2 1853	76	10D
260	Mary TROWER w of D245	7 3 1853	75	12L
261	Mary EVERSHEED of Abinger Sy d of D219 & 191	8 8 1853	53	8D
262	Arthur EVERSHEED of Arundel s of D290 & 352	22 1 1854	16	6N
263	John FANSTONE of B'hst	21 7 1854	39	7B
264	William JEAL of Newbridge Ae 2 years & 6 mos	23 2 1855	-	
265	Mary TOWSE East Lane B'hst w of Luke	4 9 1855	31	-
266	Sarah CHINNOCK of Horsham d of D137 & 225	25 1 1856	62	14K
267	Foice CHAMPION of Petworth	6 6 1856	82	-
268	Mary EVERSHEED Coldharbour Wisboro' Green a native of Lewes	3 7 1856	66	16L
269	Emma TROWER of Wood St near Guildford d D298 & 270	20 11 1856	9	22B
270	Mary Ann TROWER w of D298 & d of Tho Trower Death Certificate states died Dec 24	1 12 1856	33	22B
271	Harriet JEAL of Newbridge	7 1 1857	29	-
272	Stephen JEAL s of D271	14 1 1857	2	-
273	James TROWER s of D195	8 2 1857	12	4G
274	Rhoda TOWSE w of D192 nee Evershed died at New Buildings, Shipley	16 6 1857	68	20A
275	Mary CARTER w of D390 died at Tedfold d of D310/179	8 7 1857	30	17G
276	Ruth SPRINKS 1st w of D365	25 8 1857	59	23A
277	Elizabeth Fanstone WOODS of B'hst	11 4 1858	6m	-
278	Walter EVERSHEED s of D307 & 350	7 5 1858	30	7L
279	John s of Wm & Sarah BAKER watchmaker of Horsham	7 6 1858	3m	7Q
280	Ann TOWSE widow of Daniel at Wm Towse Five Oaks	10 6 1858	86	-
281	David Brent PRICE Richmond Sy formerly Portsmouth	20 10 1858	68	24D
282	Thomas WOODS of B'hst infant	25 10 1858	-	

DEATHS

D	Details	Date	Ae	G
283	Matthew CAFFIN B'hst East Lane 12th?	11 1 1859	80	7A
284	George KNIGHT do	13 7 1859	51	-
285	Johanna CAFFIN w of D283 (nee Towse) 3rd?	2 2 1860	81	7A
286	William TURNER 'Slaughter Farm' B'hst	13 2 1860	56	6F
287	James KNIGHT Merstham Sy	13 7 1860	25	-
288	Eleanor TOWSE w of Richard died at Bewbrush near Crawley)	1 9 1860	41	23C
289	infant son of John Dendy EVERSHEED of Cobithall	4 2 1861	-	
290	William EVERSHEED Arundel Merstham)	18 2 1861	74	6N
291	John TROWER s of D298 died at Mr Underwoods)	8 6 1861	15	22A
292	Fanny FEIST w of Frederick Horsham	6 7 1861	32	6H
293	Alice d of D292	8 8 1861	5w	6H
294	Sarah (Fanstone) WOOD Relict of John WOOD B'hst	2 3 1862	42	7B
295	Ann WOOD d of D294 Ae 18 months	2 3 1862		7B
296	George WOOD s of D294 lived a day or two	2 3 1862		
297	Fanny TROWER at Baileys Shipley	25 6 1862	12	4C
298	Thomas TROWER Bracknell Berkshire	2 8 1862	46	22A
299	James CARTER of Rowner Stoke nr Guildford	26 8 1863	70	17F
300	John TURNER s of Tho & Mary of Rosier Farm B'hst	30 9 1863	58	5A
301	William Nye STREATER of B'hst Malthouse	6 5 1864	39	2A
302	Ruth STREATER w of D301	10 5 1864	33	2A
303	Mary PARKHURST Broadbridge Heath w of D344	18 6 1864	62	6G
304	David BAKER Sen ^r B'hst	30 6 1864	69	7N
305	Elizabeth MITCHELL B'hst	14 7 1864	-	
306	Joseph EVERSHEED (from Coroner's Order for Burial)	16 9 1864	-	
307	Stephen EVERSHEED B'hst	5 11 1864	67	-
308	infant d of Wm & Emily EVERSHEED Chiltington D405)	18 11 1864	-	
309	Aaron JOHNSON Wisboro' Green	16 12 1864	65	-
310	William EVERSHEED of Tedfold B'hst	7 2 1865	80	15F
311	Elizabeth EVERSHEED of B'hst w of D358	1 3 1865	77	21A
312	Elizabeth DUFFELL of B'hst	28 2 1865	65	-
313	Mary TOWSE w of D326 West Chiltington	11 3 1865	82	5H
314	Mary Jane BAKER B'hst Ae 26 days	28 3 1865	-	
315	Mary LUXFORD B'hst d of D254 & 160	24 5 1865	64	9D
316	Mary KENSETT d of Joseph & D328 Plastow Ae 13 mos	13 10 1865		7F
317	infant son of do	15 4 1867	8d	7F
318	Charles FULLER Titeswell Rudgwick bu	3 5 1867	52	-

DEATHS

D	Details	Date	Ae	G
319	William MITCHELL B'hst	1 5 1867	52	-
320	Thomas Francis HAYWARD Petworth	17 12 1867	94	9B
321	Annetta Eliza BAKER B'hst Ae 1 year 8 mos	21 1 1868	-	-
322	Richard JEFFERY Funtington	15 3 1869	85	-
323	Jane FULLER w of D318 North Horsham	16 4 1869	78	-
324	Rhoda CARTER w of D197 North Horsham	3 5 1869	78	6K
325	Henry NAILARD North Horsham	24 9 1869	3	-
326	John TOWSE West Chilmington	8 2 1870	86	5H
327	William EVERSHEDE of Tedfold	30 5 1870	51	16H
328	Rebecca KENSETT w of Joseph D419 Plaistow	12 7 1870	36	7E
329	Beatrice Mary BAKER B'hst Ae 11 months	21 9 1870	-	-
330	Ada Victoria BAKER B'hst	16 10 1870	2	-
331	Lucy TURNER d of D300 & 346	19 10 1870	29	5B
332	Elizabeth CARTER Woking d of D407 & 409	29 10 1870	13	17B
333	Elizabeth Spencer EVERSHEDE B'hst w D357 d of D194)	13 1 1871	70	6L
334	Robert PUNTER B'hst lived $\frac{1}{2}$ hour	3 2 1871	-	-
335	Fanny KENSETT Plaistow d of D328 Ae 10 mos	8 3 1871	-	7E
336	Thomas BAKER of 'Copped Hall' B'hst	7 4 1871	84	6Q
337	Sarah JEFFERY Funtington w of D322	4 8 1871	83	24A
338	Louisa Harriet RICKETT of Cold Harbour Ae 1y 1m d of James & Louisa Elizabeth neice of D268	20 11 1871	-	16L
339	Henry TROWER Shipley	22 1 1872	54	4A
340	Rebecca Mary KENNARD B'hst	6 2 1872	59	28J
341	Hannah HERRINGTON B'hst relict of John d of Eliz (d of D93) & Richard Mutton	31 5 1872	71	13H
342	Emma Spencer EVERSHEDE d of D357 & 333	4 8 1872	49	6M
343	Edith EVERSHEDE d of D429 & 391	6 10 1872	4	26B
344	William PARKHURST Broadbridge Heath	21 9 1873	72	6G
345	Sarah MUTTON sister of D341	13 11 1873	74	13H
346	Ann Moore TURNER of Rosier Farm w of D300	3 12 1873	63	5A
347	Thomas EVERSHEDE of Cox Farm Abingers of D219 & 191	30 7 1874	70	8B
348	Mary (Ann) TROWER 'Baileys Farm' Shipley	29 7 1875	15	4C
349	James POTTER 'Marshalls' Rudgwick	1 3 1876	90	5U
350	Sarah Catherine EVERSHEDE B'hst Street w of D307	22 2 1876	75	-
351	Luke TOWSE B'hst	7 8 1876	61	-
352	Martha EVERSHEDE Croydon w of D290	22 5 1877	84	6N

DEATHS

D	Details	Date	Ae	G
353	Harriet HAYWARD w of D381 nee Evershed Wisboro' Green	2 6 1877	82	16M
354	Lois BAKER Horsham Union bu	3 10 1877	77	-
355	Anne JEFFERY Haywards Heath	12 6 1879	64	25C
356	Elizabeth POTTER B'hst Street 2nd w of D349	8 12 1879	84	5U
357	Thomas EVERSHEDE 'Dunkins Farm'	22 12 1879	86	6L
358	Sampson EVERSHEDE 'Newbuilding Farm' (Ae 92?)	2 2 1880	93	21A
359	Henry TURNER 'Rosier Farm' s of D300 & 346	30 6 1882	31	5C
360	Edward TOWSE 'Five Oaks Inn' s of D370 & 374	23 3 1883	53	5M
361	widow Aaron JOHNSON Horsham bu	25 9 1883	84	-
362	Jane EVERSHEDE Horsham d of D219 & 191	26 12 1883	77	8A
363	Rebecca KENSETT B'Hst Street d of D358 & 311 m 1st Joseph Evershed 2nd Joseph Kensett Service in Parish Church Ae 74?	25 7 1884	75	-
364	James KING B'hst	31 12 1884	60	28A
365	William SPRINKS East Street B'hst	13 4 1885	76	23A
366	Maurice EVERSHEDE Station Rd B'hst	31 5 1885	48	28H
367	Lois KENSETT Surrey w of Michael bu	14 5 1885	52	-
368	Sarah WARNER Cranley d of Sarah(d of D93) & John bu	24 11 1885	74	13N
369	Elizabeth CARTER Newfields Wisboro' Green w of D299 d of D146 & 215	19 12 1885	97	17F
370	Peter TOWSE Five Oaks B'hst	8 1 1886	83	5N
371	George KENSETT of West Croydon s of Michael	9 5 1886	21	-
372	Edwin EVERSHEDE Station Rd B'hst	13 5 1886	57	28G
373	Martha PAISLEY Woking d Joseph Farnham Hall bu	29 10 1886	72	17J
374	Francis (Frances) TOWSE Five Oaks B'Hst w of D370	21 3 1887	79	5N
375	Robert Daniel WALBEY 'Broom F Lodge' B'hst	8 11 1887	72	29J
376	Mary WARNER sister of D368 bu	3 3 1888	83	13N
377	James BATCHELOR Coolham Shipley	25 3 1888	68	-
378	Clara TROWER Gt Bookham w of D339	7 12 1888	64	4A
379	Thomas EVERSHEDE Slatter Farm	2 8 1889	58	28E
380	Robert B BLACKBURN Station Rd B'hst	17 12 1889	57	2B
381	George HAYWARD Wisboro' Green	15 9 1890	88	16M
382	John Dendy EVERSHEDE B'hst Village bro of D327	10 2 1891	67	16K
383	Ruth SPRINKS East St B'hst 2nd w of D365	24 6 1891	73	23A
384	John TOWSE New House Farm West Chilmington	16 7 1891	73	5G
385	Richard TOWSE Thakenham	24 1 1892	79	5J

DEATHS

D	Details	Date	Ae	G
386	Sarah EVERSLED Horsham d of D219 & 191	4 4 1892	83	8A
387	Clara WALBEY Bexley Heath w of D375	22 7 1892	73	29J
388	Miriam TURNER Oxted Sy w of D286	4 11 1893	83	6F
389	Mary KING Horsham w of D364	25 1 1896	65	28A
390	Henry Evershed CARTER Bramley Sy	27 4 1897	69	17G
391	Jane EVERSLED Shipley w of D429 nee Potter	28 8 1897	57	28C
392	William Knight ROWLAND West Chiltington	7 10 1897	53	29A
393	Emily EVERSLED Bakers Shipley w of D420	17 10 1897	60	29H
394	Joseph POTTER Warnham	4 3 1898	77	5S
395	Elizabeth EVERSLED B'hst w of D372	9 7 1898	67	29F
396	Agnes TOWSE Pulborough d of Anne & John TOWSE of Marble Cross	27 1 1899	35	5F
397	Ellen JEFFERY w of D402 d of D310 & 179	5 10 1899	70	23B
398	Leonard TOWSE B'hst s of D370 & 374 (Ae 65?)	13 11 1899	63	5P
399	Bessie Elizabeth Mary EVERSLED d of D372 & 395	10 1 1900	41	30E
400	William GARDNER Horsham	28 1 1900	76	16N
401	Annie TOWSE West Chiltington w of D384	2 2 1900	70	5G
402	George JEFFERY	9 3 1901	84	23B
403	Rebecca GARDNER Horsham w of D400	13 7 1901	69	16N
404	Anne TURNER of Rosier B'hst d of D300 & 346	16 8 1901	65	5D
405	William EVERSLED Nutsfield B'hst	14 3 1902	76	29D
406	Mary HEATH 2nd w of Wm Heath d of D300 & 346	24 2 1903	68	3D
407	William Evershed CARTER Park Farm Woking	23 9 1903	77	17C
408	Jane EVERSLED B'hst w of D414	24 2 1905	59	29C
409	Ellen CARTER Newfields W' Grn w of D407	1 3 1908	72	17D
410	Edgar Stanley EVERSLED Haylers Coolham eldest s of D414 & 408	9 6 1909	33	30B
411	Ernest TOWSE 67 Arundel Rd Littlehampton younger s of the late John & Anne Towse	6 11 1909	39	5E
412	Helen Maria EVERSLED Arthur Rd Horsham w of D382	28 1 1910	96	16K
413	Sarah TURNER of Rosier B'hst	22 8 1910	71	3E
414	Robert EVERSLED Haylers Farm Coolham	6 10 1910	76	29C
415	Thomas HUGHES Newbridge B'hst	21 4 1911	75	30A
416	Mary Evershed STEELE Horsham d of D299 & 369	13 7 1911	87	17E
417	Mary EVERSLED Daniels West Chiltington w of D379 nee Kensett	6 5 1912	76	28F
418	Caroline EVERSLED Malthouse Villa B'hst w of D327 nee Potter	15 6 1912	83	16J

DEATHS

D	Details	Date	Ae	G
419	Joseph KENSETT 'Brockham' Betchworth	20 8 1912	78	30C
420	Henry EVERSLED Bakers Farm Shipley	27 1 1913	86	29G
421	Emily HUGHES w of D415	14 2 1914	76	30A
422	Edith Ellen GARDNER d of D400 & 403	15 6 1914	56	16N
423	Ann BROWN 'Durlleston' Kings Rd Horsham m 1st D366 m 2nd Henry Brown at Roffey nee Muggeridge	11 10 1914	79	28H
424	Ellen MARTEN 18 Madeira Rd Streatham d of D349 & 356 Potter	18 2 1915	83	5U
425	Frank KENSETT bro of Jane D174	21 8 1915	77	30G
426	Martha Sophia EVERSLED 105 Sackfield Rd Hove d of D290 & 352	6 9 1915	95	17Q
427	Emily EVERSLED Nutsfield B'hst w of D405	18 11 1915	86	29E
428	Sarah COOK 17 Oakfield Rd Horsham	3 7 1916	76	30F
429	John Turner EVERSLED Worthing Rd Southwater	18 9 1916	80	28C
430	William TURNER Rosier B'hst	20 2 1917	61	3B
431	Esther TURNER do	27 7 1917	75	3C
432	Marguerite Victoria EVERSLED North Farm Cowfold d of D493 & 501	1 4 1918	6m	26A
433	Fanny TURNER Rosier Farm B'hst	30 5 1918	64	3C
434	Harry Moore EVERSLED Coolham youngest s of D414 & D408	11 7 1920	33	31C
435	Susan TURNER Rosier B'hst	18 11 1924	81	3F
436	Thomas TURNER do	17 7 1925	80	3A
437	Henry TOWSE Five Oaks	15 4 1927	87	5Q
438	Eliza MENDELSON Brondesbury Rd Kilburn	5 3 1928	70	31A
439	Susannah CARTER W' Grn w of D471 nee Evershed	26 9 1928	62	18C
440	Ellen CARTER Brick Croft B'hst d of D407 & 409	12 10 1928	67	17H
441	Agnes SALMON 94 London Rd Redhill nee Trower	15 12 1928	74	4D
442	Anne TOWSE w of D437	27 7 1929	87	5Q
443	James CARTER Penmount Woodland Ave Guildford	31 1 1931	72	17A
444	Sarah ROWLAND 32 Bedford Road Horsham w of D392	12 4 1931	93	29A
445	Ronald Thomas GOODALL Itchingfield	26 5 1931	16	31B
446	Ernest EVERSLED of New Zealand	15 1 1932	63	28E
447	Rosanna CARTER Stamford w of D479	1 3 1933	52	18E
448	Jane KENSETT Brockham Betchworth d of D419	21 10 1933	72	30D
449	Marjorie EVERSLED B'hst w of D507	8 3 1934	49	31D
450	Frank CARTER Stamford s of D407 & 409	22 5 1934	62	18F
451	Louisa EVERSLED The Lindens B'hst d of D327 & 418	23 9 1936	74	15L

DEATHS

D	Details	Date	Ae	G
452	Bertha EVERSHEED Glenarm Wisboro' Green youngest d of D379 & 417	1 3 1937	56	27E
453	Courtenay Thomas LAKER (suicide)	21 7 1937	46	32A
454	Albert William HAMMOND Chapel Cottage South St B'hst	2 1 1939	72	30H
455	Bessie Rosina HUNT Newfields W' Grn	20 2 1939	24	31E
456	Jane EVERSHEED Brockhamlea East St B'hst eldest d of D379 & 417	4 4 1939	75	27D
457	Herbert EVERSHEED Beedings Cottage N Heath Pulborough younger s of D405 & 427	5 7 1939	70	27A
458	Clara Elizabeth TROWER 12 Hampton Pl Brighton	13 4 1940	79	4D
459	Jonathan GOODALL Streele Farm B'hst	25 5 1940	85	32D
460	Alexander Thompson MYLLES do	24 6 1941	73	33B
461	William GOODALL Hill Crest Midhurst s of D463	1 11 1941	8m	33A
462	Thomas Henry HUNT The Lindens B'hst	19 1 1942	57	31F
463	Eric Walter GOODALL Red Roofs Capel	29 3 1942	28	33A
464	William Potter EVERSHEED 12 High St Tonbridge elder s of D327 & 418	24 3 1944	77	15M
465	Henry James MARTEN 18 Madeira Rd Streatham cremated 12 April bu 15 April	4 4 1944	86	5R
466	Thirza Jane LAKER 'Tayntlands' South St B'hst Service in the Parish Church by the Vicar	16 11 1944	78	32G
467	Rev Harry Edward HAYCOCK 'Porch Brook House' cr Rock Kidderminster cr B'ham bu 29 April	8 3 1945	77	31J
468	Rev William Henry SANDS Brick Croft Villas B'hst	11 8 1945	76	33G
469	Edward Philip POAT 2 Arundel Cottages B'hst	18 11 1945	68	17P
470	Thomas EVERSHEED Leacroft Coneyhurst B'hst	10 2 1946	75	18A
471	Henry Edward CARTER Brookbridge W' Grn late of Old Woking Sy	20 2 1946	82	18B
472	Thomas LAKER South St B'hst	30 5 1947	82	32G
473	Violet Evelyn SCOGGINS 3 Brick Croft Villas B'Hst	20 6 1947	42	33F
474	Robert Spencer EVERSHEED 2 Brick Croft do	8 10 1948	71	3G
475	Agnes Ada EVERSHEED Laurence House Slinfold gravestone erected by her natural son	20 11 1948	65	3J
476	Sidney CARTER Glenarm Wisboro' Green	25 11 1948	81	18H
477	Thomas EVERSHEED Beedings Cottage Pulborough	1 12 1948	82	27B
478	Frederick William HUNT The Lindens B'hst	25 4 1949	73	31G
479	Evershed CARTER Orchard House Priory Road cr at Kettering Stamford	6 5 1950	76	18D
480	Mary CARTER Glenarm W' Gn widow of D476	5 10 1950	79	18H

DEATHS

D	Details	Date	Ae	G
481	Margaret POAT 2 Arundel Cottages B'hst	31 10 1950	73	17N
482	AnneTaylor MORTON (Moreton) Elmcroft B'hst	27 12 1950	90	17K
483	Elizabeth EVERSHEED Brookhamlea East St B'hst cremated at Woking	14 12 1951	76	27D
484	Margaret MARTEN 39 Sandy Lane South Wallington cremated at Croydon	30 1 1952	84	16N
485	Florence Evelyn CARTER Willow Way Finchley w of D443 cremated at Golders Green bu	8 12 1953 10 1 1954	71	17A
486	William EVERSHEED Daniels Coneyhurst B'hst	28 5 1954	80	27F
487	Walter GOODALL	28 5 1954	74	33A
488	Mary WEEKS Chapel Cottage High St B'hst cremated at Brighton sister of D454	21 12 1954	78	30H
489	Anna Moore CARTER Greyfriars Ryhall Rd Stamford cremated at Kettering	13 2 1955	87	18G
490	Annie Louisa HAYCOCK 14 Woodland Rd Hassocks cremated at Brighton w of D467	5 1 1957	75	31J
491	Maud Emma Alice CARTER Brookbridge W' Gn cremated at Crawley	27 12 1957	89	32H
492	John James EVERSHEED North View Daux Ave B'hst s of D327 & 418	13 8 1958	89	15E
493	Lucy Elizabeth EVERSHEED Laurence House Slinfold w of D501	25 12 1958	79	1B
494	Sophia HUNT Oakhurst Nursing Home Midhurst	24 4 1959	84	31H
495	Arthur Potter EVERSHEED Bines Station Rd B'hst	18 6 1959	74	19D
496	Margaret Elizabeth MARTEN Gratwick House B'hst w of D465 d of D327 & 418 cr at Crawley	11 11 1960	96	5R
497	Annie EVERSHEED Daniels Coneyhurst B'hst w of D486 cremated at Crawley	22 10 1961	75	27F
498	Lily GOODALL Garrards Farm Uffington Berks w of D459 late of Streele Farm	25 12 1962	99	32D
499	Norman CARTER Newfields Wisboro' Green cremated at Crawley	12 10 1964	69	19C
500	Annie GOODALL Coffsland Farm Nuthurst Horsham	24 6 1965	81	32B
501	Hubert Charles EVERSHEED 110 High St B'hst late of Slinfold & North Farm Cowfold 1st s of D 429 (see also 2nd son Percy Maurice Evershed 1873-1967 noted on the MI)	22 8 1965	94	1A
502	Matilda GOODALL	22 1 1967	83	33A
503	Kate HAYNES of Worthing	4 10 1967	68	33E
504	Alexander Isgrove HAYNES of Worthing	26 6 1968	68	33E

DEATHS

D	Details	Date	Ae	G
505	Gertrude Anne EVERSLED London	26 12 1969	88	19E
506	Dorothy Millicent EVERSLED Leamington w of D492	16 11 1970	91	15E
507	Walter Ellis EVERSLED B'hst widower of D449	11 12 1971	90	31D
508	Jesse Emily MYLLES B'hst widow of D460	28 2 1972	92	33B
509	Lilian Louisa EVERSLED High St B'hst d of D429 see also Mabel Nelly Evershed noted on the MI who died in New Zealand 1970 Ae 94	22 3 1973	92	19B
510	Flora McDonald FREEMAN High St B'hst service in the Parish Church by the Vicar	29 7 1973	98	1C
511	Isaac FREEMAN Longfield B'hst service as for D510	31 3 1974	86	1C
512	Frank WILLIAMS Brick Croft High St B'hst service as for D510	11 12 1975	80	32F
513	Charles Joseph MARTEN Nethercote Storrington cremated at Worthing bu 19 9 1976	17 12 1975	100	16N
514	Ina Kathleen LAKER Slinfold	22 9 1978	85	33H
515	Florence Mary EVERSLED Longfield B'hst widow of D474	14 2 1979	94	3H
516	Madeline Dorothy BEARD Mellor Derbyshire elder d of D492 & 506 cremated at Stockport 4 2 1980 interred 15 6 1980	29 1 1980	74	15D
517	Ena May BISS 88 Broadwater Road Worthing cremated at Worthing 10 6 1980 interred 3 8 1980	5 6 1980	73	19G
518	Cyril Henry MATTHEWS	15 10 1980	80	19H

COMPOSITE
REGISTER
OF
MONUMENTAL
INSCRIPTIONS

1A	HS: In loving memory of Hubert Charles Evershed 1871-1965 and Percy Maurice Evershed MRCVS of Nottingham 1873-1967 1st and 2nd sons of John Turner Evershed	501
1B	HS: In memory of Lucy Elizabeth beloved wife of Hubert Charles Evershed who died Dec 25th 1958 Aged 79	493
1C	HS: In memory of Flora McDonald Freeman died 29th July 1973 Aged 98 And her husband Isaac died 31st March 1974 Aged 86 'At Rest'	510 511
2A	DHS: LH: In memory of William Nye Streater who died May 6th (1864) Aged (39) years RH: In memory of Ruth (wife) of William Nye Streater who died May 10th (1864) Aged (33) years	301 302
2B	HS: Sacred to the memory of Robert Blackburn (13 years minister of this Chapel) Died ... 1889 Aged 57 years	380
2C	HS: In memory of Sarah wife of William Mitchelmore of She departed this life Jan 17 1840 at Buckman Corner in this Parish Aged 77 years	200
3A	HS: In loving memory of Thomas Turner (of Rosier) who died July 17th 1925 Aged 80 years	436
3B	HS: In memory of William Turner of Rosier who died Febry 21st 1917 Aged 61 years	430
3C	HS: In memory of Esther Turner Born March 14th 1842 Died July 27th 1917 Also of Fanny Turner Born March 14th 1854 Died May 29th 1918 both of Rosier	431 433
3D	HS: In Memory of Mary Second Wife of William Heath of Storrington & Daughter of John & Ann M Turner who passed away Feb 24th 1903 Aged 68 years	406
3E	HS: In memory of Sarah Turner (of Rosier) who died August 22nd 1910 Aged 71 years	413
3F	HS: In loving memory of Susan Turner (of Rosier) who died November 18th 1924 Aged 81 years	435
3G	HS: In memory of Robert Spencer Evershed 2nd son of the late Robert Evershed of Coneyhurst Farm Died October 8th 1948 Aged 71 years	474
3H	HS: In memory of Florence Mary Evershed wife of Robert Spencer Evershed Died February 14th 1979 Aged 94 years	515
3J	HS: Coneyhurst In loving memory of Agnes Ada Evershed who passed away on 20th November 1948	475

G	MONUMENTAL INSCRIPTIONS	D
4A	HS: In Memory of Henry Trower who died at Shipley Janry 22nd 1872 Aged 54 years In Loving Remembrance of Clara his wife who died Decbr 7th 1888 Aged 64 years FS: HT 1872 CT 1888	339 378
4B	blank	
4C	HS: In Memory of Fanny Daughter of Henry and Clara Trower who died June 23rd 1862 in the 12th year of her age Also Mary Ann Daughter of the above who died July 29th 1875 in the 13th year of her age FS: FT 1862 MAT 1875	297
4D	HS: In loving memory of Agnes Salmon who died Dec 15th 1928 Aged 75 years. Also of her sister Clara Elizabeth Trower who died April 13th 1940 Daughter of Henry and Clara Trower FS: AS 1928 CET 1860-1940	441 458
4E	blank	
4F	sHS: In memory of Caroline Daughter of John & Jane Trower of Reigate Surrey who died April 28th 1817 Aged 16 months FS: worn	239
4G	HS: In memory of James Trower who died in London October 14th 1837 Aged 53 years. Also James son of the above who died in Feb 8th 1857 (?) Aged 12 years	195 273
5A	HS: In Memory of John Turner (Late of Rosier) Son of Thomas & Mary Turner who died Sept 30th 1863 Aged 58 years Also Ann Moore Turner Wife of the above who died December 3rd 1873 Aged 63 years	300 346
5B	HS: In Memory of Lucy Daughter of John & Ann Moore Turner who died Oct 19th 1870 Aged 29 years	331
5C	HS: In Memory of Henry Son of John and Ann Moore Turner (of Rosier) who died June 30th 1882 Aged 31 years	359
5D	HS: In Memory of Anne Daughter of John and Ann Moore Turner Born May 29th 1836 Died August 16th 1901	404
5E	HS: In affectionate memory of Ernest Towse youngest son of the late John & Anne Towse Died November 5th 1909 Aged 39 years	411
5F	HS: In affectionate remembrance of Agnes, Daughter of Annie and John Towse Died Janry 27th 1899	396
5G	Coffin Slab: LH: In affectionate remembrance of John Towse of New House Farm West Chiltington who departed this life July 16th 1891 Aged 75 years RH: In affectionate remembrance of Annie wife of John Towse who departed this life Febry 2nd 1900 in her 71st year	384 481
5H	Flat Slab: (John & Mary Towse) FS: MT 1868 JT 1870	313 & 326
5J	HS: broken, inscription lost Richard Towse	385
5K	and 5L - space for one grave only	

G	MONUMENTAL INSCRIPTIONS	D
5M	HS: In memory of Edward, son of Peter & Frances Towse who died March 23rd 1883 Aged 53 years	360
5N	DHS: LH: In memory of Peter Towse who died Jan 8th 1886 Aged 83 years RH: In memory of Frabces wife of Peter Towse who died March 21 1887 Aged 79 years	370 374
5P	HS: In memory of Leonard son of Peter & Frances Towse who died Nover 13 1899 Aged 65 years	398
5Q	HS: In memory of Harry son of Peter & Frances Towse who died April 15th 1927 Aged 87 years Also of Ann Towse wife of the above Died July 27th 1929 Aged 87 years	437 442
5R	HS: Sacred to the Memory of Henry James Marten who died 4th April 1944 Aged 86 years. Also Margaret Elizabeth wife of the above who died 11th Nov 1960 Aged 96 years. Younger daughter of William Evershed of Tedfold FS: HJM 1944	465 496
5S	HS: In memory of Joseph Potter who died March 4th 1898 Aged 77 years Also of Harriet who died June 5th 1831 Aged 15 Mary died Nov 5th 1834 Aged 25 Ann died Decbr 27th 1835 Aged 15 (13?) Eliza died Sepbr 15th 1836 Aged 18 sisters of the above And of their Mother Hannah, First wife of James Potter (rest of inscription worn)	394 175 186 188 190 136
5T	blank	
5U	HS: In memory of James Potter who died March 1st 1876 Aged 90 years. Also of Elizabeth the wife of the above who died Decbr 8th 1879 in her 85th year Also Ellen wife of Love Marten and daughter of the above who died Feb 18th 1915 in her (84th) year Cremated at Golders Green (her ashes placed) here 'Peace to the quite dead'	349 356 424
5V	blank	
5W	DHS: LH: In memory of John Cooter who died the 9th of Dec 1852 Aged 84 years RH: In memory of Elizabeth wife of John Cooter who died the 25th of March 1846 Aged 77 years FS: worn	258 234
6A	HS: In Memory of Thomas Turner (of Palmers) who died the 6th of Sept 1837 Aged 67 years Also Mary the Wife of Thomas Turner who died the 7th of October 1839 Aged 69 years	194 198
6B	HS: In Memory of John Turner of Rosier who died the 1st July 1843 Aged 84 years	218

G	MONUMENTAL INSCRIPTIONS	D
6C	HS: In Memory of William Turner who died the 26th of December 1845 Aged 84 years	231
6D	In Memory of Ann Turner (Spinster) who died the 13th of October 1847 Aged 82 years	242
6E	In Memory of Jane Daughter of Thomas & Mary Turner who died March 20th 1848 Aged 40 years	248
6F	HS: In Memory of William Turner who departed this life February the 13th 1860 Aged 56 years Also Miriam wife of the above who died November 4th 1893 Aged 84 years	286 388
6G	Sacred to the memory of William Parkhurst who died September 22nd 1878 Aged 72 years Also of Mary, wife of the above who died June 18th 1864 Aged 62 years FS: WP 1873 MP 1864	344 303
6H	HS: In Memory of Fanny Wife of Frederick Feist who died July 6th 1861 Aged 32 years Also of Alice Infant Daughter of the above who died August .. 1861 Aged 6 (weeks)	292 293
6J	HS: In Memory of William Carter who departed this life (11th) of February 1839 Aged 54 years	197
6K	HS: In Memory of Rhoda Carter Wife of William Carter who departed this life the 2nd of May 1869 Aged 78 years ' In the great cloister	324
6L	DHS: LH: In Memory of Thomas Evershed (Late of Dunkins) who died Decr 22nd 1879 Aged 86 years RH: In Memory of Elizth Spencer Wife of Thomas Evershed & Eldest Daughter of Thos & Mary Turner (of Palmers) who died Janry 14th 1871 Aged 70 years	357 333
6M	HS: In Memory of Emma Spencer the Affectionate Daughter of Thomas & Elizabeth Evershed (Late of Dunkins) who departed this life the 4th of August 1872 Aged 49 years	342
6N	Low Altar Tomb: In a vault beneath are deposited the remains of Alfred son of William and Martha Evershed of Arundel who died August 24th 1840 Aged 16 years Also Sophia Sale their daughter who died May 1st 1843 Aged 17 years Also Arthur son of the above who died January 22nd 1854 Aged 16 years Also in Memory of William Evershed of Arundel born 8th April 1786 died 18th February 1861 Also Martha wife of William Evershed who died May 22nd 1877 Aged 84 Years	203 217 262 290 352

G	MONUMENTAL INSCRIPTIONS	D
6P	DHS: (much worn)LH: In memory of ...(James) Baker who departed this life 28th April 1833 Aged 44 years RH:... .. Mary wife of James Baker who departed this life the 4th of November 1840 Aged 43 years	196 210
6Q	DHS: LH: In Memory of Thomas Baker of Co... who died April 7th 1871 In his (85th) year RH: In Memory of Ann Wife of Thomas Baker who died June (?) 30th 1845 Aged 50 years	336 228
6R	HS: In Memory of Ann, Daughter of Thomas and Ann Baker who died March (9th) 1844 Aged 28 years	220
6S	HS: Sacred to the Memory of Edwin, Son of Thomas and Ann Baker who died August 23rd 1837 Aged 2 years & 2 months	193
7A	HS: In Memory of Matthew Caffyn who died (January) 12th 1839 Also Johanna wife of Matthew Caffyn who died Feb (3rd) 1860 Aged 81 years Also Matthew son of (the above) who died March 11th (1822) Aged (7) Months Also Jane daughter of the above who died November 27th 1829 Aged 13 years FS: MC 1839 JC 1860 MC 1822 JC 1829	283 285 130 173
7B	HS: In Memory of John Fanstone born Feby 8th 1815 died July 21st 1854 Also Sarah, wife of the above born March 25th 1819 died March 2nd 1862 'Believe on the Lord Jesus Christ, and thou shalt be saved' Erected by an affectionate son FS: JF 1854 SF 1862	263 294
7C	and 7D blank	
7E	HS: In Memory of Rebecca wife of Joseph Kensett who died July 12th 1870 Aged 36 years Also of Fanny Daughter of the above who died March 8th 1871 Aged 10 months	328 335
7F	HS: In Memory of Mary Daughter of Joseph & Rebecca Kensett who died October 13th 1865 Aged 1 year & 6 months Also of an Infant Son who died April 15th 1867 Aged 8 days	316 317
7G	HS: Sacred to the memory of Ellen Daughter of Peter & Susannah Kensett who died Nov 23rd 1833 Aged 5 years 6 months	182
7H	HS: Sacred to the memory of Jane the Daughter of Peter & Susannah Kensett who departed this life the 12th of Janry 1831 Aged 7 years	174
7J	HS: Sacred to the memory of Fanny Daughter of Peter & Susannah Kensett who died Sept 12th 1845 Aged 10 years	229
7K	blank	

G	MONUMENTAL INSCRIPTIONS	D
7L	HS: In memory of Walter, son of Stephen & Sarah Catherine Evershed who died May 7 1858 Aged 30 years Also Leonard their Son who died June 30th 1834 Aged 2 years Also George Thomas their Son who died Dec 17 1847 Aged 4 years	278 184 243
7M	HS: In Memory of John Worswell died Nov 29 1826 Aged 29 years	164
7N	HS: To the Memory of David Baker who died the 30th June 1864 Aged 68 years 'My flesh also shall rest in hope' FS: DB 1864	304
7P	HS: Th the Memory of Eunice, the Wife of David Baker who died the 17th of December 1831 Aged 28 years 'She was an affectionate wife, A tender Mother, And a sincere Friend' Voice - Mason FS: EB 1831	178
7Q	HS: In Memory of John Baker son of William and Sarah Baker who died May 11th 1858 Aged 5 Months FS: JB 1858	279
8A	HS: In memory of Jane Evershed daughter of Thomas and Elizabeth (of Abinger) who died Dec 26 1887 Aged 7 years Also of Sarah Evershed sister of the above who died April 4th 1892 in the 84th year of her age	362 386
8B	HS: In memory of Thomas Evershed son of Thomas and Elizabeth (of Abinger) who died July 30th 1874 Aged 70 years	347
8C	HS: Sacred to the memory of Rebecca, daughter of Thomas and Evershed who died the 22nd of September 1824 Aged 25 years Also two children who died infants	144
8D	HS: In memory of Mary Evershed daughter of Thomas and Elizabeth Evershed who departed this life August 8th 1853 Aged 52 years	261
9A	blank	
9B	HS: Sacred to the memory of Thomas Francis Hayward who died (December 17th 1867) aged 94 years 'Called to Jesus' FS: blank	320
9C	HS: inscription worn FS: JEH 1803 AH 1809 MAH 1815 RH 1819 85 98 109 118	
9D	HS: LH: In Memory of Mr Richard Evershed (of Newbridge) who died the 3rd of Sepbr 1850 Aged 76 years RH: In Memory of Elizabeth Wife of Richd Evershed (of Newbridge) who died the 2nd of July 1826 Aged 54 Also of Mary Luxford Daughter of the above who died May 24th 1865 Aged 63 years	254 160 315
9E	HS: In Memory of Richard Evershed son of Richard and Elizabeth Evershed of Newbridge who departed this life the 19th of August 1799 Aged 6 days 'Happy the Babe who privileg'd by fate To shorter Labour and a Lighter weight &c' (now worn)	77

G	MONUMENTAL INSCRIPTIONS	D
9F	HS: In Memory of Sarah Evershed Daughter of Richard and Elizabeth Evershed of Newbridge who departed this life the 24th of Decr 1819 Aged 7 years	120
9G	HS: inscription worn ... Edward (Evershed) ...	177
9H	HS: inscription worn .. William (Evershed) .. (s of) Richard ..	183
9J	DHS: LH: In Memory of Thomas Evershed (of Abinger Surrey) who died July 4th 1843 Aged 78 years RH: In Memory of Elizabeth wife of Thomas Evershed of Abinger, Surrey who died February (8) 1837 Aged 67 years	219 191
9K	HS: To the Memory of Elizabeth the Daughter of Thomas and Elizabeth Evershed who died the 17th of July 1800 Aged 2 years and 6 months ' some lines not recorded by RB'	80
9L	DHS: LH: In memory of Joseph Potter who died June 15th 1801 Aged 45 years RH: In memory of Jane wife of Joseph Potter who died March 14th 1830 Aged 78 years	81 189
10A	HS: Inscription worn: Martha Hard	88
10B	HS: (To the) Memory (of) William Browne who died the 30th March 1847 Aged 85 years	237
10C	HS: with coffin slab on the ground Beneath this place is deposited the Remains of Mr John Browne of Pulborough He died of the smallpox the 15th day of October 1788 Aged (29) years FS: blank	68
10D	DHS: LH: In Memory of Stephen Knight (who) died Feb 6th 1853 Aged 76 years RH: Elizabeth wife of Stephe Knight died July 8th 1811 Aged 32 years FS: blank	259 108
10E	HS: To the Memory of Selina, Daughter of Thomas & Mary who died 10th July 1811 Aged 4 years and 4 months	104
11A	DHS: LH: Sacred to the memory of Thomas Towse who died Octr 14th 1828 Aged 60 years RH: Sacred to the memory of Jane wife of Thomas Towse who died Febry 24th 1819 Aged 37 years 'Here we have no continuing City But we seek one to come'	168 100
11B	the grave of John Towse (no headstone)	100
11C	Small HS: Janes son of John & Elizabeth Cooter of Pulborough Died November 25th (1808) Aged 4 years and 10 months	97
11D	Small HS & FS: Mattie Cooter: inscription worn	95
11F	Small HS: In memory of Jesse Baker son of ... remainder of inscription obscured: FS: blank	65

G	MONUMENTAL INSCRIPTIONS	D
11G	DHS: LH: To the memory of Joseph Potter who died September 15th 1781 Aged 75 years RH: To the memory of Elizabeth wife of Joseph Potter who died June 20th 1788 Aged 71 years FS: worn	53 59
11H	HS: James Knight .. died on (Nov) 4th 1808 Aged .5 years Ann wife of James Knight .. died Dec 3rd 1839 Aged 85 years Ann Daughter of James & Ann Knight died Feb 5th (1788) Aged 10 weeks FS; JK 1808 AK 1839 AK 1788	96 199 58
11J	HS: Jane Knight wife of Stephen Knight died Feb 13 1848 Aged 66 years: FS: SK 1853	246
11K	Tiny HS: Ann Knight FS: worn (not identified)	
11L	DHS: LH: James Knight died Nov .. 1811 Aged 81 years RH: Mary wife of James Knight died Aug 11th 1848 Aged 77 years FS: worn	105 116
11M	Emily Daughter of Stephen & Elizabeth Knight who died October the 15th 1826 Aged 20 years FS: worn	163
12A	HS: In memory of Jesse son of Arthur Baker who departed this life the 22nd of April 1796 Aged 32 years 'Take heed, Watch and pray, for ye know not when the time is, and what I say unto you I say unto all, Watch' Also Sarah daughter of the same, died April the 5th 1799 Agd 29 years	70 76
12B	blank	
12C	HS: In memory of Arthur Baker who died November 17th 1779 Aged 42 years 'Reader, yet a little while, and thou shalt be with me' In memory of Alice wife of Arthur Baker who died April 3rd 1803 Aged 65 years 'It is good for me that I have been afflicted' Also in memory of James and Elizabeth, son and daughter of the above, who died infants	49 84 50 51
12D	HS: In memory of Mary widow of Thomas Towse who died the 12th of November 1804 Aged 59 years	83
12E	HS: In memory of Thomas Towse of Andrews Hill who died the 16th of November 1796 Aged 59 years	72
12F	HS: To the memory of Sarah wife of Adam Baker who died November 13th 1795 Aged 33 years	69
12G	HS: In memory of Isaac son of William and Rachael Ludby of Petworth who died December 9th 1789 Aged 1 year & 6 months 'How lov'd how valu'd once avails thee not; To whom related or by whom begot A Heap of dust alone remains of thee Tis all thou are and all the proud shall be'	61

G	MONUMENTAL INSCRIPTIONS	D
12H	HS: Sacred to he memory of Adam Baker who departed this life the 20th(?) of March 1827 Aged 80 years	166
12J	& 12K blank	
12L	DHS: LH: To the memory of James Trower (of Rowfold) who died Feb 1st 1848 Aged 73 years 'Let your moderation be known unto all men, the Lord is at hand' RH: To the memory of Mary wife of James Trower who died March 7th 1853 Aged 75 years 'Rejoice in Hope, Be patient in Tribulation Continuing instant in Prayer' E Voice Mason FS: JT 1848 MT 1853	245 260
12M	DHS: LH: In memory of Richard Bourn who died 1807 Aged 87 years (2 lines indicipherable) RH: In memory of Hannah wife of Richard Bourn who died Feb ye ... 1793 Aged 72 years 'Spectator pray remember this How frail ... thy life a sudden stroke as death gave me with ... may counsel thee'	91 67
12N	blank	
12P	DHS: LH: In memory of John Trower who died 10 April 1817 Aged 70 years RH: In memory of Hannah wife of John Trower who died 22nd June 1815 Aged 68 years FS: JT 1817 HT 1815	114 111
13A	HS: In memory of Susan wife of John Dean of Shipley who died April ye 26th 1760 Aged 73 (63?) years	8
13B	DHS: LH: In memory of Arthur Baker who died the 8th of December 1844 Aged 77 years RH: In memory of Elizabeth wife of Arthur Baker who died the 10th of April 1850 Aged 80 years	226 252
13C	DHS:LH: In memory of Elizabeth wife of Simqn Baker who died the 19th of March 1816 in the 28th year of her age Also of four children who died infants 'Thy will be done' incription worn	112
13D	Slab: Parential Gratitude To the memory of Mary the daughter of Arthur and Elizabeth Baker who departed this life the 13th of June 1819 aged 17 years 'poetry - illegible'	119

G	MONUMENTAL INSCRIPTIONS	D
13E	HS: Near this stone lieth the body of Sarah daughter of Edward and Jane Evershed who died the 24th of June 1785 aged 2 years and 11 months Also Mary their daughter died the 9th of May 1797 aged 5 years Also George their son died the 24th of April 1798 aged 4 years Also Elizabeth their daughter died the 21st of June 1798 aged 17 years and 9 months	56 73 74 75
13F	and 13G blank	
13H	DHS: LH: In memory of Hannah Relict of John Herington who died May 31st 1872 Aged 70 years 'Her end was peace' RH: In memory of Sarah Mutton who died November 13th 1873 Aged 74 years 'Entered into rest'	341 345
13J	HS: In memory of Richard Mutton who died December 8th 1810 Aged 80 years: Also Sarah wife of the above who died May 4th 1778 Aged 42 years	101 46
13K	DHS: LH: In memory of John Bourn who died August ye 3rd 1785 Aged 80 years: RH: Also Mary wife of John Bourn who died February ye 28th 1790 Aged 79 years 'Death is the painful way that all must tread Joyful to them that are by virtue led They happy are who thus to Heaven engage Their YOUTH'S first Choice and last desire in AGE'	57 63
13L	HS: In memory of William son of Reuben and Jane Baker who died February the 8th 1766 aged 1 year and 5 months 'Repine not at my early call to rest For endless joys I left my mother's breast O blessed charge tho' in thy junial days Reprievd from care to sing thy Maker's praise'	18
13M	HS: In memory of Thomas Mutton who died April the 18th 1812 Aged 42 years 'Weep not for me, my Wife and Children dear I am not dead but lies sleeping here' Also Mary his Wife died April the 15 1822 Aged 50 years	106 131
13N	HS: In loving memory of Sarah Warner of Cranleigh who died the 16th of Novbr 1885 Aged 74 years 'My presence shall go with thee, and I will give thee rest' Also of Mary Warner who died the 28th of Feb 1888 Aged 83 years 'Thy righteousness shall be in everlasting remembrance'	368 376
14A	blank	
14B	DHS: LH: In memory of Edward Evershed who died the 4th of Febr 1841 Aged 86 years RH: In memory of Jane wife of Edward Evershed who died the 24th of June 1801 Aged 41 years	211 83

G	MONUMENTAL INSCRIPTIONS	D
14C	DHS: LH: Sacred to the memory of Richard Evershed of Street who departed this life 13th April 1840 Aged 90 years RH: Sacred to the memory of Ann the wife of John Evershed of Street who departed this life 30th of May 1821 Aged 75 years	202 124
14D	HS: In memory of Elizabeth the wife of Benjamin Challen and daughter of Richard and Mary Evershed; who departed this life the 30th of March 1775 Aged 22 years 'Except a man be born again he cannot see the kingdom of God' John ch.3 v.3 'Therefore prepare to meet thy God O Israel' Amos ch.4 v.12	36
14E	DHS: LH: In memory of Richard Evershed who depated this life the 7th of February 1784 Aged 62 years 'After a lingering illness of grief and pain When Doctor's skill and Physic proved in vain With Christian patience he resigned his breath To God that gave it hope of Life in Death' RH: In memory of Mary the wife of Richard Evershed who departed this life the 28th of November 1774 Aged 48 years 'From grief from pain and anxious care My God doth give me rest My children dear live in God's fear And be forever blessed'	55 35
14F	blank	
14G	DHS: LH: In memory of Thomas Evershed who died April ye 28 1785 Aged 86 years RH: In memory of Elizabeth wife of Thomas Evershed who died February ye 1st 1768	15 19
14H	HS: In memory of John Evershed Junior who died March ye 4th 1779 Aged 25 years 'My time was short attended with much pain But welcome Death by thee I hope to gain A place of rest which my dear Lord doth give For here on Earth no pleasure is to live'	48
14J	DHS: LH: In memory of John Evershed of Rushwood Common who died the 7th of January 1807 Aged 86 years 'The hoary head is a crown of glory If it be found in the way of righteousness' RH: In memory of Elizabeth wife of John Evershed. She died the 13th of February 1792 Aged 66 years 'Pray murmur not I you exhort In FAITH and HOPE be strong The troubles of this life are short Eternity is long'	93 66
14K	HS: In memory of Sarah wife of William Chinnock who departed this life January 25th 1856 in the 63rd year of her age	266

G	MONUMENTAL INSCRIPTIONS	D
14L	HS: In memory of Alfred Chinnock the beloved son of William and Sarah Chinnock who departed this life on the 28th of September 1850 Aged 16 years	255
14M	HS: In memory of Frank son of John and Louisa Evershed (of Albury) who died the 16th of October 1829 Aged 2 years 6 months	171
14N	DHS: LH: In memory of Giles Evershed (of Shalford formerly Rushett) who died the 11th day of Oct 1822 Aged 64 years RH: In memory of Elizabeth wife of Giles Evershed who died the 26th of Oct 1844 Aged 86 years	137 255
14P	Noted by FE as 'possibly a double grave - apparently there was never more than a small headstone & footstone, without any inscription'	
15A	HS: John Ellis died July the 4th 1804 Aged 83 years Elizabeth the wife of John Ellis died Feb the 13th 1804 Aged 72 years	89 87
15B	Here stood a rail bearing an illegible inscription and seen by FE circa 1878	
15C	HS: In memory of William Potter who died the 2nd of March 1793 Aged 29 years 'How sudden and how awful was the stroke By which the slender thread of life was broke Oh may this admonition teach us all How frail is man how unforeseen his fall'	68
15D	Rail: In memory of Richard Jupp who died 22nd October 1828 Aged 82 years 'Go home dear friends and shed no tears For here we lie till Christ appears And at his call we hope to have A joyful rising from the grave' In memory of Susanna wife of Richard Jupp who died November 16th 1828 Aged 80 years 'Yea tho' I walk through the valley of the shadow of death, I fear no evil; for thou art with with me O Lord my God; thy rod and staff comfort me' The above was seen by FE but is now gone. On this plot there is now a tablet recording: Madeline Dorothy Beard who died at Mellor, Derbyshire on 29th January 1980 Aged 73 years Cremated at Stockport 4th Feb 1980 Interment at Billingshurst 15th June 1980	169 170 516
15F	DHS: LH: Sacred to the memory of William Evershed (of Tedfold) who departed this life Feb 7th 1865 Aged 80 years RH: Sacred to the memory of Henrietta wife of William Evershed (of Tedfold) who departed this life April 20 1832 Aged 41 years	310 179
15G	blank	

G	MONUMENTAL INSCRIPTIONS	D
15H	HS: To the memory of William Evershed (of Tedfold) who departed this life December 22nd 1824 Aged 70 years Also Sarah the wife of the above who died July the 29th 1842 Aged 88 years	146 215
15J	HS: Mary daughter of William Evershed of Tedfold died the 30th of November 1813 Aged 27 years 'Wisdom is a gray hair And an unspotted life is old age' Wisdom	107
15K	HS: In memory of Mary wife of William Evershed She died the 4th of Novemner 1790 Aged 28 'A virtuous Wife in prime of life By Death is snatched away Her soul is blessed and gone to rest Tho' flesh is turned to clay She's left behind a Husband kind Two daughters and a son May they prepare to meet her where True love will never be done'	64
15L	HS: Sacred to the memory of Louisa Evershed daughter of William and Caroline Evershed who departed this life September 23rd 1936 Aged 74	451
15M	HS: William Potter Evershed stone lying on the ground with the inscription obscured	464
15N	HS: In memory of Mary daughter of Richard and Mary Evershed who died the 14th of December 1810 Aged 17 years	102
15P	HS: In memory of Richard Evershed who died the 12th of April 1811 Aged 54 years In memory of Mary wife of Richard Evershed who died the 26th of November 1821 Aged 66 years	105 125
15Q	Rail: In memory of Mary wife of John Sayers Died the 15th January 1804 Aged 89 years 'While here on Earth I did remain My latter days were grief and pain But when the Lord did think it best He took me to a place of rest' (the above seen and recorded by FE but no longer extant)	86
16F	HS: In memory of Ann daughter of William and Henrietta Evershed (of Tedfold) who departed this life September 30 1844 Aged 22 years	223
16H	HS: Sacred to the memory of William Evershed (of Tedfold) who died May 30th 1870 Aged 51 years	327
16J	HS: Sacred to the memory of Caroline wife of William Evershed (of Tedfold) who died June 15th 1912 Aged 83 years	418

G	MONUMENTAL INSCRIPTIONS	D
16K	DHS: LH: In affectionate remembrance of John Dendy Evershed who died February 10th 1891 Aged 67 years 'Not lost but gone before' LH: In affectionate remembrance of Helen Maria wife of John Dendy Evershed who died Janry 28th 1910 Aged 96 years	382 412
16L	HS: In memory of Mary Evershed who died July 3rd 1856 Aged 66 years Also Louisa Harriet Rickett, neice of the above, and beloved child of James and Louisa Rickett who died November 20th 1871 Aged 13 months	268 338
16M	HS: In memory of Harriet the beloved wife of George Hayward of Wisborough Green who died June 2nd 1877 Aged 82 years	353
16N	HS: In remembrance of William Gardner Born Nov 15 1823 Died Jan 28th 1900 Also Rebecca wife of the above Born March 22nd 1832 Died July 18th 1901 Also Edith Ellen Gardner daughter of the above Born Novr 29th 1857 Died June 15th 1914 Also Margaret Marten daughter of the above and wife of Charles Joseph Marten Born June 3rd 1867 Died Jan 30th 1952 also on a slab within the grave dwarf surround wall Charles Joseph Marten husband of Margaret Died 17th December 1975 in his 101st year A beloved father, grandfather and great grandfather	400 403 422 484 513
17A	HS: In loving memory of James Carter second son of William and Ellen Carter of Park Farm Woking and founder of the firm of Carter Bros Engineers Billingshurst who fell asleep January 31st 1931 Aged 72 years 'And we know that all things work together for good to them that love God, to them who are called according to his purpose' (Check details of wife Florence)	443 485
17B	HS: In affectionate remembrance of Elizabeth Carter daughter of William Evershed and Ellen Carter Obit October 25th 1870 Aetat 13 'Blessed are the pure in heart for they shall see God'	403
17C	HS: In memory of William Evershed Carter (of Park Farm Woking) Died Septbr 23rd 1903 Aged 78 years Voice - Mason	407
17D	HS: In loving memory of Ellen wife of William Evershed Carter Died May 1st 1908 Aged 72 years	409
17E	HS: In loving memory of Mary Evershed wife of John Steele of Horsham and daughter of James & Elizabeth Carter Born Nov 4th 1823 Died July 13th 1911 'Until the day break and the shadows flee away'	416

G	MONUMENTAL INSCRIPTIONS	D
17F	HS: Sacred to the memory of James Carter Born at Rowner July 7th 1795 Died August 24th 1863 Aged 70 years Also Elizabeth wife of James Carter and Daughter of William Evershed Born at Eashing Surrey August 28th 1788 Died at Newfields, Wisboro Green Dec 19th 1855 in her 90th year 'To them who be patient continuance in well doing seek for glory and honour and immortality, eternal life' Romans II Chap 7v Voice - Mason	299 369
17G	HS: In memory of Mary the beloved wife of Henry Evershed Carter who died July 18th 1847 Aged 30 years Also Henry Evershed Carter who died April 27th 1897 Aged 69 years	275 390
17H	HS: In loving memory of Ellen Carter daughter of William Evershed and Ellen Carter who died October 12th 1928 'So he brought them to their desired haven then they are glad because they be at rest'	440
17J	HS: In memory of Martha Pislely daughter of Joseph Pislely (of Farnham Mill) who died October 24th 1886 Aged 73 years 'They (lines worn)	373
17K	sHS: Anne Taylor Morton Born 24 May 1860 Died 27 December 1950	482
17L	and 17M blank	
17N	Margaret Poat (no stone)	481
17P	Edward Philip Poat (no stone)	469
17Q	sHS: In loving memory of Martha Sophia Evershed daughter of William and Martha Evershed late of Arundel Born July 21st 1820 Died September 6th 1915 RIP 'Peace Perfect Peace'	426
18A	HS: In loving memory of Thomas Evershed who died February 19th 1946 Aged 75 years	470
18B	HS: In memory of Henry Edward Carter of Brookbridge Wisboro Green formerly of Shack .. and late of Park Farm Woking Third son of William and Ellen Carter Entered into eternal life Feb 20th 1946 Aged 82 years 'The best actions are for others done For others burns the brightest loves fire For others are the hardest battles won'	471
18C	HS: In loving memory of Susanna Carter beloved wife of Henry Evershed Carter Entered into eternal rest September 26th 1928 Aged 62 years 'At rest in the Lord'	439

G	MONUMENTAL INSCRIPTIONS	D
18D	HS: In loving memory of Evershed (Tod) Carter of Woking and Stamford died May 6th 1950 Aged 76 years 'But they shall strengthen the state of the world, and their prayer shall be in the work of their craft'	479
18E	HS: In loving memory of Rosanna Carter wife of Evershed Carter who fell asleep March 1st 1933 Aged 52 years 'If on a spring night I went by and God was standing there What is the prayer that I would cry to Him ? This is my prayer O Lord of courage grave O Master of this night of spring Make firm in me a heart too brave to ask thee anything'	447
18F	HS: (worn) Frank Carter	450
18G	HS: In loving memory of Anna Moore Carter of Grey Friars Stamford Died 13th Feb 1955 in her 87th year Wife of Frank Carter	489
18H	DHS: In loving memory of Sidney Carter of Glenarm Wisboro Green second eldest son of William Evershed and Ellen Carter Co-Founder of Carter Bros Reliance Works Wisboro Green Died Nov 25th 1948 Aged 81 years Also of Mary wife of the above For many years organist of the Chapel Died October 5th 1950 Aged 79 'When cometh joyful rest with spirit of the just'	259 480
19A	blank	
19B	HS: In memory of Lilian Louise Evershed Died 22nd March 1973 Aged 92 And Mabel Nellie Evershed Died in New Zealand in 1940 Aged 94 Daughters of James Turner Evershed	509
19C	HS: Norman Carter Feb 25,1895 Oct 12,1964 'Beloved'	499
19D	HS: In loving memory of Arthur Potter Evershed MC Died 18 June 1959 Aged 74 'At Rest' And his wife Gertrude Annie Died 26th Dec 1969 Aged 88	495
19E	Part of plot 19D	
19F	blank	
19G	HS: In loving memory of Ena May Biss Died 5 June 1980 Aged 88	517
19H	HS: In dearest memory of Cyril Henry Matthews Died 15th October 1980 Aged 80 years	518

G	MONUMENTAL INSCRIPTIONS	D
20A	HS: In memory of William Towse who died July 8th 1837 Aged 55 (?) years Also of Rhoda, wife of William Towse who died July 16th 1857 Aged 68 years FS: WT 1837 RT 1857	192 274
20B	HS: In memory of Thomas Letter Taylor (Minister) who died the 9th of September 1820 Aged 26 years Also of Mrs Catherine Taylor who departed this life July 17th 1834 in her 41st year and was interred at Worship Street Chapel London 'Thanks be to God who giveth Victory through our Lord Jesus Christ' 1 Cor: 15 Ch 57 Ver	122
20C	HS: Draped figure studying a book: Thomas Evershed who died the 9th of November 1827 Aged 71 years 'Happy is that people, that is in such a case Yea, happy is that people, whose God is the Lord' Psalm 144th verse 15	167
	Also Mary wife of the above who died March 30th 1840 Aged 77 years	201
20D	HS: In memory of Thomas son of Arthur and Mary Greenfield who died the 3 of September 1804 Aged 17 years five lines of poetry (worn)	90
20E	HS: Design as 20: William Evershed Forty four years Pastor of this Church died July the 6th 1799 Aged 80 years Mary Evershed relict of William Evershed died the 5th of September 1799 Aged 80 years 'Blessed are the dead which die in the Lord from henceforth: Yea, saith the Spirit, that they may rest from their labours; and their works do follow them' (Inscription worn) Rev. Chap 14 verse 13	78 79
20F	HS: In memory of Mary wife of Arthur Greenfield who died the 21st of December 1816 Aged 69 years	113
20G	HS: In memory of John Evershed who died July the 30th 1809 Aged 64 years	99
20H	HS: Sacred to the memory of Ann the wife of John Evershed who died September 23rd 1826 Aged 64 years	162
21A	HS: In memory of Elizabeth wife of Sampson Evershed who died March 1st 1865 In memory of Sampson Evershed who died February 2nd 1880 Aged 92 years	311 358
21B	HS: Sacred to the memory of John Streater who died April 22nd 1847 Aged 64 years 'May all our Lamps be Trimmed' Also Anne, wife of the above who died Decbr 26, 1845 Aged 62 years 'Prepare to meet thy God' FS: JS 1847 AS 1845	238 232

G	MONUMENTAL INSCRIPTIONS	D
22A	HS: In loving memory of Thomas Trower who died August 3rd 1863 Aged 46 years Also John son of Thomas & Mary Ann Trower who died June 8th 1861 Aged 15 (? worn) years FS: TT 1862 JT 1861	298 291
22B	HS: In loving memory of Mary Ann, wife of Thomas Trower who died Decbr 1st 1856 Aged 33 years 'Many are the afflictions of the righteous: but the Lord delivereth him out of them all' (Ps 34.19) Also Emma their daughter who died Novr 20 1856 Aged 9 years	270 269
22C	HS: In memory of Thomas Puttock who died 25th April .. (worn) Aged 51 years Also Elizabeth (worn) who departed this life Jan .. (worn) .. Aged 82 years	205 206
23A	DHS: In memory of William Sprinks who departed this life the 13th of April 1885 Aged 76 years 'Thy will be done' In memory of Ruth, wife of William Sprinks who departed this life the 25th of August 1857 Aged 59 years Also Ruth 3rd wife of the above Died June 24th 1891 Aged 59 years Coffin Slab & FS: RS 1857 WS 1885	276 365 383
23B	HS: In loving memory of George Jeffery Died March 9th 1901 Aged 84 years Also Ellen wife of the above Died October 5th 1899 Aged 70 years 'Till the day break, and the shadows flee away'	402 397
23C	HS: Sacred to the memory of Eleanor wife of Richard Towse who died September 2nd 1860 Aged 41 years FS: ET 1860	288
23D	HS: .. (worn) .. Thomas Puttock who died .. the 12th 18.. Aged .. years Edward their son died April 28 1819 (?) aged .. months Also Charlottee their daughter died May .. 1827 (?) Age 15 years (Register states 'Elizabeth')	207 208 209
24A	DHS: In memory of Richard Jeffery who departed this life at West Ashling near Chichester March 13th 1869 Aged 85 years In memory of Sarah wife of Richard Jeffery who departed this life August 3rd 1871 Aged 83 years and 5 months FS: blank	322 337
24B	HS: Louisa Caroline wife of John Jeffery died January 3rd 1801 Aged 24 years John Jeffery died June 14th 1815 Aged 35 years FS: worn	94 110
24C	DHS: In memory of John Jeffery who died August 28th 1824 Aged 74 years In memory of Ann wife of John Jeffery who died November 3rd 1824 Aged 73 years Two FS: JJ 1824 AJ 1824	143 145
24D	HS: In memory of David Brent Price formerly of Portsmouth who died Octr 20th 1858 in his 69th year Also Rebecca his wife nee Jeffery who died June 27th 1830 Aged 39 years Buried in ... (obscured by FS) ... Chapel Yard FS: DBP 1858	281 172

G	MONUMENTAL INSCRIPTIONS	D
24E	HS: Inscription worn (Elizabeth Puttock ?)	
25A	HS: Cherubs head between two vases and ornamented chains wreathed In memory of Ann Daughter of John and Anne Jeffery who died the 1st of August 1796 Aged 12 years 6 lines of poetry (worn)	71
25B	DHS: LH: .. Eliza daughter of John & Ann Jeffery who died May 20th 1817 Aged 28 years RH: .. Jane daughter of John & Ann Jeffery who died Feb 25th 1820 Aged 33 years	115 121
25C	HS: In memory of Anne Jeffery who died June 12th 1879 in the 65th year of her age	355
26A	blank	
26B	HS: In Affectionate Remembrance of Edith Daughter of John Turner and Jane Evershed of Station Villa, Billingshurst who died October 6th 1872 Aged 3 years and 6 months 'Suffer little children to come unto me'	343
27A	HS: In loving memory of Herbert Evershed younger son of the late William & Emily Evershed of Nutsfield, Billingshurst who passed on 5th July 1939 Aged 69 years 'At Rest'	457
27B	HS: In loving memory of Thomas Evershed eldest son of the late William & Emily Evershed of Nutsfield, Billingshurst who passed on 1st Dec 1948 Aged 82 years	477
27C	blank	
27D	HS with stone surround to the grave: In loving memory of Jane Evershed of Brockhamlea, Billingshurst who passed on April 4th 1939 Aged 75 years Also of Elizabeth Evershed died December 14th 1951 Aged 76 years 'The spirit who in them did sing To us his music lendeth T. H. Gill'	456 483
27E	HS with stone surround: In memory of Bertha, youngest daughter of Thomas & Mary Evershed who passed on March 1st 1937 Aged 56 years 'Blessed are they who bestow love on others throughout the long day'	452
27F	HS: In memory of William Evershed died 28th May 1954	486
28A	HS: In loving memory of James King who died December 31st 1880 Aged 60 years Also of Mary wife of the above who died at Horsham January 25th 1896 Aged 65 years	364 389
28B	blank	

28C	HS: In ever loving memory of Jane wife of John Turner Evershed (late of Ewhurst) who departed this life August 27th 1897 Aged 58 years 'Kind Mother Tenderest Mother below suddenly taken from earth we know labour is over God has given her grace and may we meet in thy manor of peace' Also of John Turner Evershed who died Sept 18th 1916 Aged 80 years	391 429
28D	blank	
28E	HS: In loving memory of Thomas Evershed of Slatter Farm Entered into rest August 2nd 1889 Aged 58 years 'Thy will be done' Also Ernest son of the above who died at Tauranga New Zealand on Jan 15th 1932 Aged 63 years	379 446
28F	HS: In loving memory of Mary Evershed widow of the late Thomas Evershed of Slatter Farm who entered into rest May 6th 1912 Aged 76 years 'At Rest'	417
28G	HS: In loving remembrance of Edwin Evershed who fell asleep in Jesus May 13th 1886 Aged 57 years 'Them also that are fallen asleep in Jesus will God bring with him'	372
28H	HS: Sacred to the memory of Maurice Evershed who departed this life May 31st 1885 Aged 48 years 'Thy will be done' Anne wife of the above who died Oct 11th 1914 Aged 73 years	366 423
28J	HS: Sacred to the memory of Rebecca Mary Kennard late of Sevenoaks who departed this life February 16th 1872 'Believing in Jesus she met her death without tears Guard this sacred treasure ever faithful tomb Keep it undisturbed till the master come'	340
29A	HS: In loving memory of William Knight Rowland of West Chiltonington who died October 7th 1897 Aged 55 ? years 'Shall not the judge of the whole earth do right' And of Sarah Rowland his wife who died April 12th 1931 Aged 93 years 'At rest'	392 444
29B	blank	
29C	HS: In loving memory of Jane wife of Robert Evershed (late of Coneyhurst) who departed this life February 24th 1905 Aged 58 years Also of Robert Evershed who died October 6th 1910 in his 77th year	408 414
29D	HS: In affectionate remembrance of William Evershed (of Nutsfield) who entered into rest March 14th 1902 Aged 76 years 'His end was peace'	405

29E	HS: In affectionate memory of Emily wife of William Evershed (of Nutsfield) who entered into rest November 17th 1915 Aged 86 years 'The toilful day of life is o'er'	427
29F	HS: In loving memory of Elizabeth wife of Edwin Evershed who entered into rest July 9th 1898 Aged 67 years 'The more in heaven to welcome us when we are called o God'	395
29G	HS: In loving memory of Henry Evershed late of Bakers Farm Shipley who entered into rest January 27th 1913 in his 87th year 'At rest'	420
29H	HS: In loving memory of Emily wife of Henry Evershed who departed this life Octbr 17th 1897 Aged 60 years	393
29J	Stone Cross: Sacred to the memory of Robert Daniel Walby Born January 2nd 1815 Died November 8th 1887 Also of Clara wife of Robert Daniel Walby who died at Bexley Heath July 18th 1892 Aged 73 years	375 387
30A	HS: In loving memory of Thomas Hughes who died April 20th 1911 Aged 75 years Also Emily, his wife who died Feb 14th 1914 Aged 76 years 'For by grace are ye saved through faith' Eph 2 Ch 8	415 421
30B	HS: Sacred to the memory of Edgar Stanley elder son of Robert and Jane Evershed who departed this life Jan 5th 1909 in his 34th year 'What I do thou knoweth not now but thou shalt know hereafter' St John XIII VII	410
30C	HS: In loving memory of Joseph Kensett formerly of Plastow Sussex and latterly of Brockham Surrey who passed into the higher life 18th August 1912 Aged 78 years	419
30D	HS: In loving memory of Jane Kensett daughter of Joseph Kensett who died 21st Oct 1933 Aged 72 years 'There is no death in Gods wide world But the eternal scene of change The flag of life is never furled It only taketh wider range'	448
30E	HS: In loving memory of Bessie Elizabeth Mary daughter of Edwin and Elizabeth Evershed who passed away January 10th 1900 Aged 41 years 'Be ye also ready'	399
30F	No stone - grave of Sarah Cook	428
30G	HS: In Memoriam Frank Kensett late of this Parish youngest son of Peter and Susanna Kensett Born 23rd Feb 1838 died 21st August 1915 'Lighten our darkness'	425

G	MONUMENTAL INSCRIPTIONS	D
30H	HS: In loving memory of Albert William Hammond Passed over Jan 2nd 1939 Aged 72 years Also Mary Weeks sister of the above Died Dec 21st 1954 Aged 78	454 488
31A	HS:(fallen) In loving memory of Eliza Mendelsohn who died March 5th 1928 Aged 70 years 'Blessed are those who die in the Lord'	438
31B	Stone surround: In loving remembrance of our dear Ronald Thomas Goodall 11.1.1919 - 26.5.1931 'Onward'	445
31C	HS: Sacred to the memory of Harry Moore youngest son of the late Robert & Jane Evershed of Conehurst Farm Billingshurst who departed this life July 11th 1920 in his 34th year FS: HME 1920	434
31D	HS: In loving memory of Marjory, the beloved wife of Ellis Evershed who fell asleep March 8th 1934 Aged 49 years 'At rest' Also her husband Ellis who entered into rest December 11th 1971 Aged 90 years	449 507
31E	HS with stone surround: In loving memory of Bessie Rosina Hunt Born March 28 1914 Passed on Feb 20 1939 'Holiness is an infinite compassion for others'	455
31F	HS: In loving memory of my dear husband Thomas Henry Hunt Died 19th January 1942 Aged 57	462
31G	HS: In loving memory of my dear husband Frederick William Hunt Died 25th April 1949 Aged 73	478
31H	HS: In loving memory of Sophia wife of Frederick William Hunt Died August 25th 1959 Aged 84 'Remember'	494
31J	Wooden Cross: In Remembrance Harry Howard Haycock Annie Louise Haycock	467 490
32A	Stone surround to grave: Courtenay Thomas Laker Died July 21st 1937 Aged 46	453
32B	HS with stone surround: Dearly beloved by all who knew her most especially her children Annie Goodall Died 24 June 1965 Aged 81 years 'I need thee, oh, I need thee every hour'	500
32C	blank	
32D	HS: John Goodall 1855 - 1940 His beloved wife Lily 1863 - 1962 'God is life'	459 498
32E	blank	
32F	No stone grave of Frank Williams	512

G	MONUMENTAL INSCRIPTIONS	D
32G	Stone surround to grave: Thomas Laker At Rest May 30 1947 In loving remembrance of Thirza Jane Laker At Rest Nov 16 1944	472 466
32H	HS: In loving memory of Maude Emma Alice Carter of Hayes & Billingshurst (late of Biggleswade) who died 27th December 1857 Aged 88 years 'One who never turned her back but marched breast forward' R Browning	273
33A	HS & stone surround: In loving memory of Eric Walter Goodall Died March 29th 1942 Aged 28 years Also William Walter Goodall son of the above Died November 1st 1941 Aged 8 months 'Thy will be done' Also Walter Goodall died May 26 1951 Aged 74 years On stone slab: Matilda Goodall died 22nd January 1967 Aged 83 years	463 461 487 502
33B	Stone Book: In loving memory of Alexander Thompson Mylles Died 23rd June 1941 Aged 72 Jesse Emily his beloved wife died 28 Feb 1972 Aged 85	460 508
33C	blank	
33D	HS: Here rest the ashes of Kitty Haynes 4th October 1967 And her beloved husband Sandy 26 June 1969	- -
33E	Unmarked grave of Kate Haynes and Alexander Isgrove Haynes	503 504
33F	Unmarked grave of Violet Evelyn Scoggins	473
33G	Unmarked grave of Rev William Henry Sands	468
33H	HS: In loving memory of Ina Kathleen Laker Died 22nd September 1978 Aged 55 years	514

PLAN OF THE
BURIAL GROUND

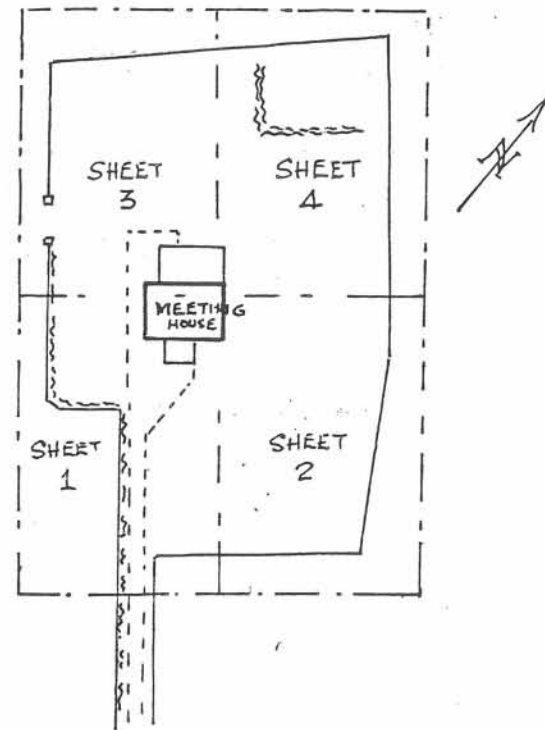

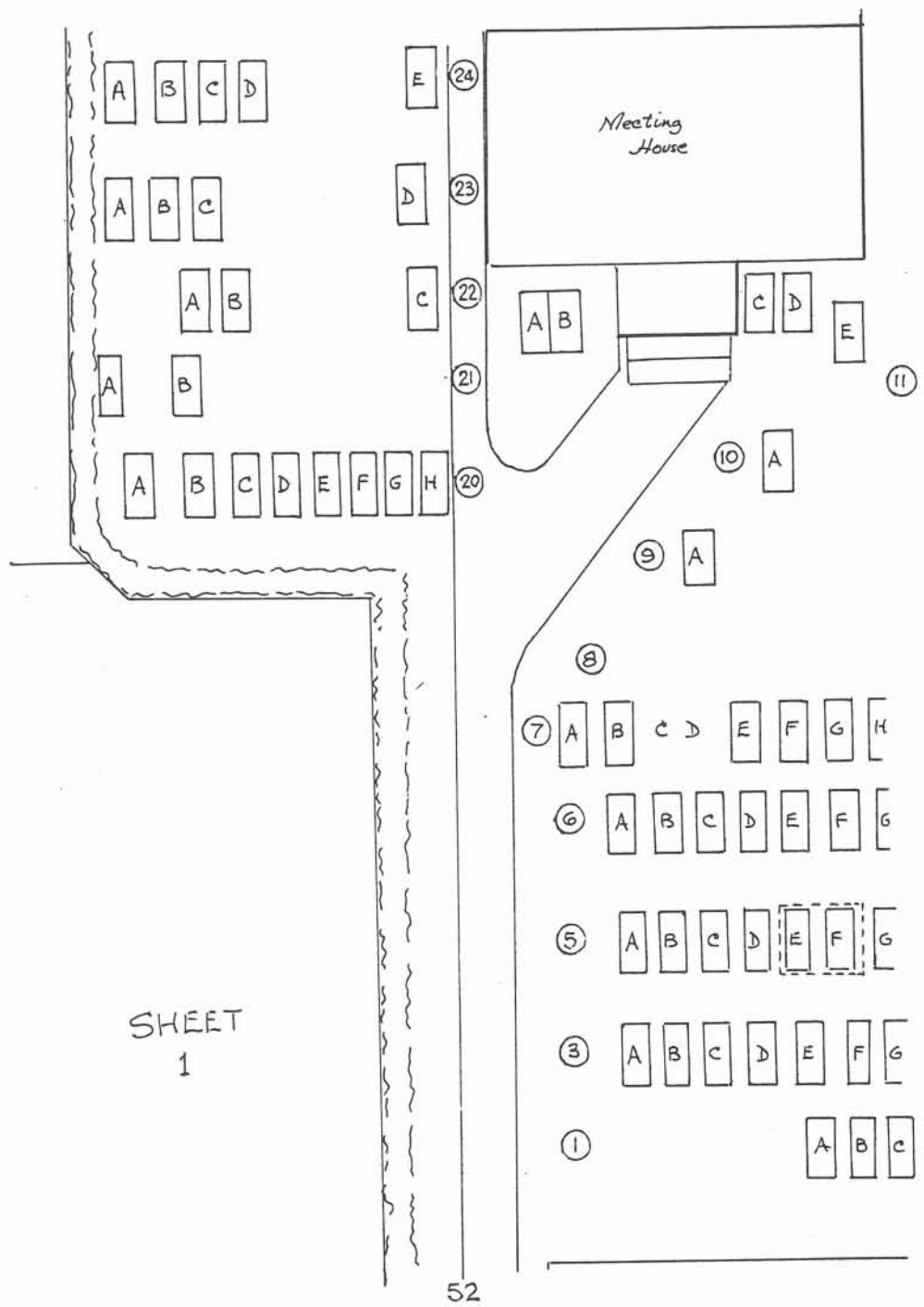

SHEET
1

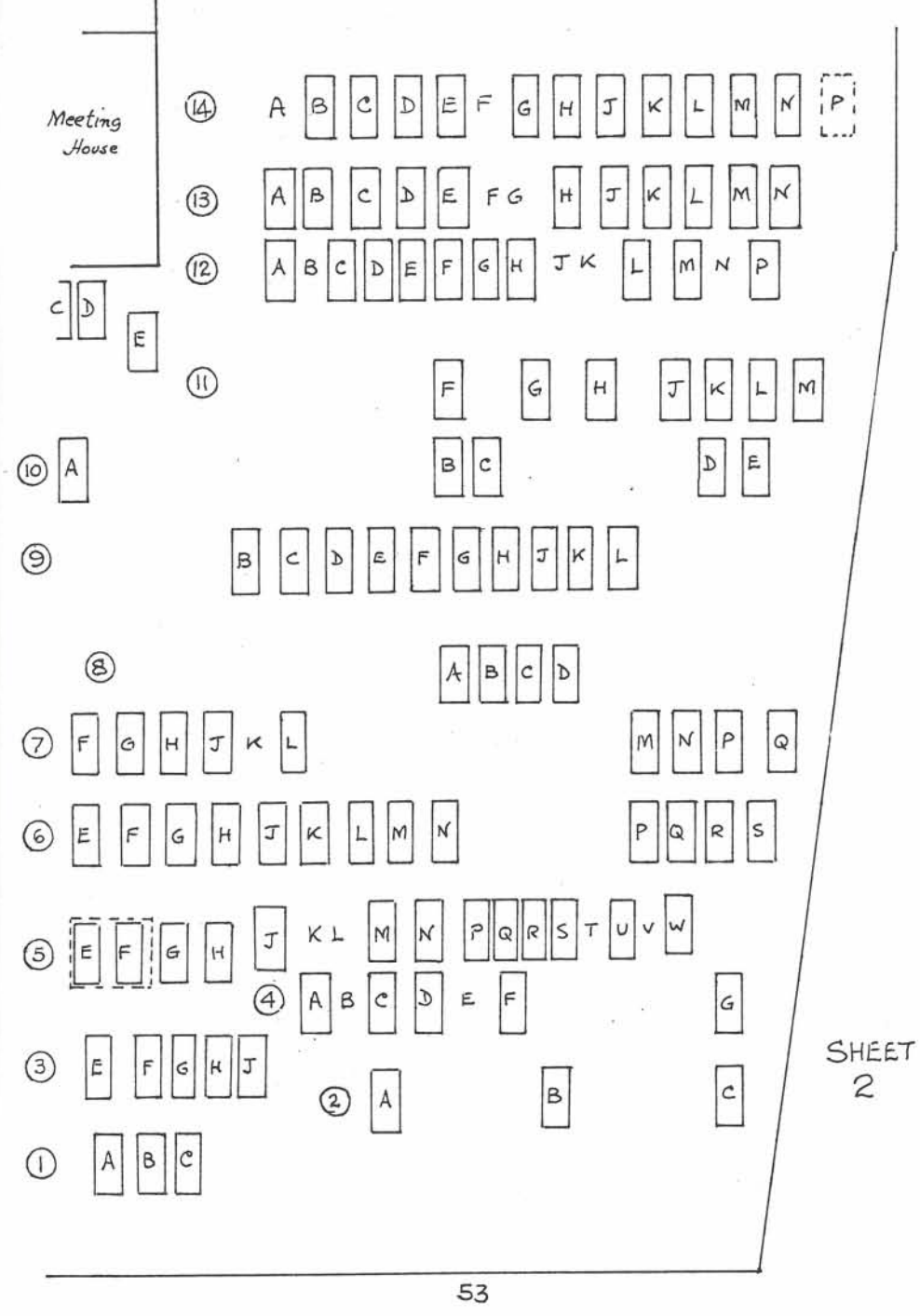

SHEET
2

A B C D E F G H (33)

A B C D E F G H (32)

A B C D E F G H J (31)

A B C D E F G H (30)

A B C D E F G H J (29)

A B C D E F G H J (28)

A B C D E F (27)

A B (26)

A B C

A B C D

(25)

E (24)

54

SHEET 3

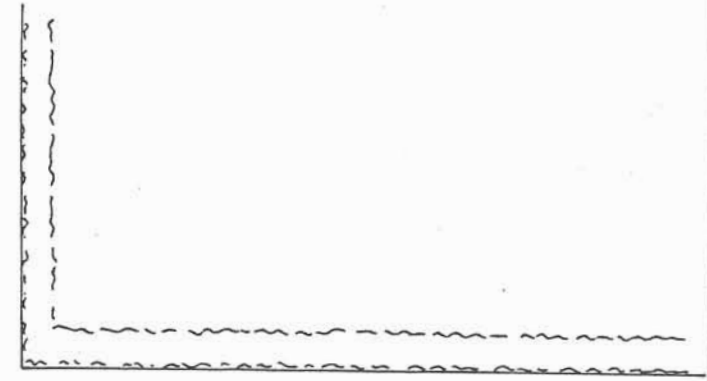
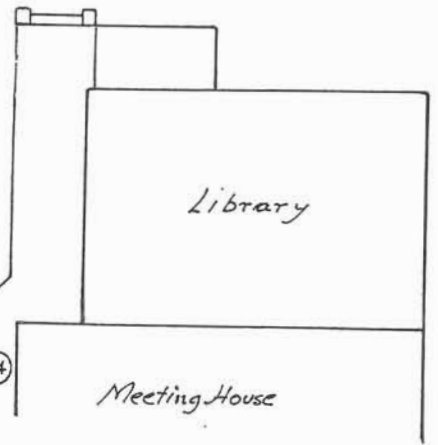

(19) A B C D E F G H

(18) A B C D E F G H

(17) A B C D E F G H J K LM N P Q

SHEET 4

(16) A B C D E F G H J K L M N

(15) A B C D E F G H J K L M N P
raise raise Q

(14) A B C D E F G H J K L M N P

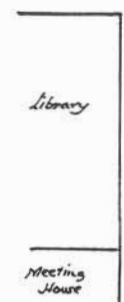

55

INDEX OF PERSONS

giving the Deaths Register serial numbers of those
persons listed in this work

BAKER	CLARKE 161
Ada 330 Adam 26,69,166	COOK 428
Alice 84 Ann 220,228	COOTER 95,97,234,258
Annetta 321	CRAGG 165,221,224
Arthur 28,41,226	
Beatrice 329 David 304	DEAN 8
Edwin 193	DENDY 11
Elizabeth 51,112,252	DENMAN 251
Eunice 178 Frederick 153	DUFFELL 312
James 50,196 Jane 18	
Jesse 65,70	ELLIS 87,89,159
John 3,127,128,235,279	ELPHICK 204
Lois 354 Mark 129 Martha 154	EVANS 22,54,159
Mary 119,210,314 Matthew 128	EVERSHED
Reuben 18 Sampson 151	Agnes 475 Alfred 203
Sarah 69,76,127,128,279	Ann 124,162,223 Annie 497
Simon 30 Thomas 336	Arthur 262,495 Bertha 452
Widow 52 William 18,279	Bessie 399 Caroline 418
BATCHELOR 277	Dorothy 506 Edgar 410
BAX 16	Edith 343 Edward 177,211
BEARD 516	Edwin 372
BENNETT 4,38	Elizabeth 66,75,80,147,160,191, 225,240,311,333,395,483
BISS 517	Emily 308,393,427
BLACKBURN 380	Emma 342 Ernest 446
BOOKER 43	Florence 515 Frank 171
BOURN 57,63,67,91,140	George 74,123,243 Gertrude 505
BROWN 424 BROWNE 13,60,237	Giles 137 Harry 434
BUCKMAN 250	Helen 412 Henrietta 179
BURCHILL 2	Henry 420 Herbert 457
	Hubert 501 James 213
CAFFYN (IN) 130,173,283,285	Jane 82,240,362,391,408,456
CARTER	John 25,48,86,93,99,171,202, 216,230,289,382,429,492
Anna 489 Ellen 409,440	Joseph 306,363 Leonard 184
Elizabeth 332,369	Lilian 509 Louise 451
Evershed 479	Lucy 493 Mabel G19B
Florence 485 Frank 450	Marguerite 432
Henry 390,471 James 299,443	Marjorie 449 Martha 352,426
Mary 275,480 Maud 491	Mary 35,64,73,79,102,107,125, 201,261,268,417
Norman 499 Rhoda 324	Maurice 366 Percy 501
Rosanna 447 Sidney 476	Rebecca 144
Susanna 439 William 197,407	Richard 17,23,35,55,77,103,254
CHALLENGE 36	Robert 414,474 Sampson 358
CHAMPION 267	
CHARMAN 44	
CHINNOCK 255,266	

INDEX OF PERSONS

EVERSHED (Contd)
 Sarah 56,120,215,350,386
 Selina 104 Sophia 217
 Stephen 307
 Thomas 15,62,78,167,219,347,
 357,470,477
 Walter 278,507
 William 146,193,290,308,310,
 327,405,464,486

FANSTONE 263
 FEIST 292
 FREEMAN 510,511
 FULLER 318,323

GARDNER 400,403,422
 GEORGE 132,149
 GOODALL 445,461,463,487,
 498,500,502
 GREENFIELD 14,90,113

HARD 88
 HAMMOND 54
 HASLEDEN 32
 HAWKINS 135,176,187
 HAYCOCK 467,490
 HAYNES 503,504
 HAYWARD
 Ann 98,222 George 381
 Harriet 353 John 85
 Mary 109 Richard 118
 Thomas 320
 HEATH 406
 HERRINGTON 341
 HUGHES 415,421
 HUNT 455,462,478,494

JEAL 264,271,272
 JEFFERY
 Ann(e) 71,145,355
 Elizabeth 115 Ellen 397
 George 402 Jane 121
 John 110,143
 Louise 94 Richard 322
 Sarah 337
 JOHNSON 309,361
 JUPP 169,170

KENNARD 340
 KENSETT
 Ellen 182 Fanny 229,335
 Frank 425 George 371
 Inf 317 Jane 174,448
 Joseph 316 &c,419
 Lois 367 Mary 316

KENSETT (Contd)
 Peter 174 &c Rebecca 328,363
 Susanna 174 &c
 KING 364,389
 KNIGHT
 Ann 58,199 Elizabeth 108,157
 Emily 163 George 284
 Hannah 138 James 96,105,187
 Jane 246 John 39 Mary 116
 Sarah 155 Stephen 259
 Walter 9

LAKER 453,466,472,514
 LUDDY 61
 LUXFORD 315

MARTEN 424,465,484,496,513
 MATTHEWS 518
 MENDELSON 438
 MITCHELL 305,319
 MITCHELMORE 200
 MORTON 482
 MUTTON 46,101,106,131,341,345
 MYLLES 460,508

NAILARD 325
 NASH 139

PAISLEY 373
 PARKHURST 303,344
 PRICE 172,281
 POAT 469,481
 POPE 156
 POTTER
 Alfred 158 Ann 188
 Elizabeth 59,190,356
 Harriet 175 James 349
 Jane 189 Joseph 81,394
 Mary 186 William 10,33,68
 PUTTOCK (POTOCK)
 Charlotte 148
 Edward 208 Eliza 206
 Elizabeth 209, G24E
 Hannah 141 Horatio 180
 Reginald 133 Samuel 12
 Thomas 21,205 Widow 40

RICKETT 338
 ROWLAND 392,444

SALMON 441
 SANDS 468
 SAYERS 86
 SCOGGINS 473
 SENDAL 7

INDEX OF PERSONS

SPRINKS 276,365,383
 STEARS (STEERE) 24,31,34,37,
 45,212,214
 STEELE 416
 STOVEL 20
 STREATER 232,233,238,301,302

TAYLOR 122,152,185
 TOWSE
 Agnes 396 Alfred 256
 Ann 280,396 &c Anne 401
 Caroline 181 Daniel 247
 Edward 360 Edwin 227
 Eleanor 288 Ernest 411
 James 249 Jane 100
 Johanna 285
 John 326,384,396 &c
 Fanny 92 Francis(es) 374
 Leonard 398 Luke 249,351
 Mary 83,265,313 Peter 370
 Rhoda 274 Richard 385
 Thomas 72,168
 Widow 47 William 192

TROWER
 Caleb 244 Caroline 239
 Clara 257,378,458
 Elizabeth 253
 Emma 269 Fanny 297
 Hannah 111 Henry 339
 James 195,245,273
 John 114,291
 Mary 260,270,348
 Thomas 298

TURNER
 Ann(e) 242,346,404
 Esther 431 Fanny 433
 Henry 359 Jane 236,248
 John 218,300 Lucy 331
 Mary 198 Miriam 388
 Sarah 413 Susan 435
 Thomas 194,436
 Widow 27
 William 231,286,430

WALBY 375,387
 WARNER 368,376
 WEEKS 488
 WELLS 241
 WHALES 1,6
 WHEELER 5
 WILLIAMS 512
 WORSFOLD 164
 WOOD(s) 277,282,294,296

BILLINGSHURST MEETING HOUSE REGISTERS
ERRATA SHEET

Since the publication of this book in October 1985 a number of errors have been discovered in the text. These are listed below. The Editor would be grateful if recipients of this list will paste it to the flysheet of the copy of the book in their possession for the better guidance of such students as may consult it in the future.

Leonard J Maguire

April 1987

REGISTER OF DEATHS (D1,2 &c)

2	BURCHILE not Burchill	318	Titesell not Titeswell
19	add d 1.2.1768 (FE)		also delete Ae 52
41	add h of D84 Ae 42 G12C	322	add G24A
46	add 13H	341	HERINGTON not Herrington
49	delete entry	347	Abinger not Abingers
56	82 not 83	355	bu 16.6.1879
65	delete Ae 91	368	d 16.11.1885 d of Sarah & John
70	D 41 & 84 not 49 & 85	373	d 24.10.1886
73	82 not 83	376	d 28.2.1888
76	add d of D41 & 84	383	3rd wife not 2nd
79	80 not 82	387	d 18.7.1892
84	D41 not 49	419	d 18.8.1912
85	add s of 222	420	Lane not Farm
100	24.2.1819 not 21.2 1810	443	Wodeland not Woodland
112	add Ae 27	467	1944 not 1945
116	Ae 77	469	Arundale not Arundel
117	add see D100	481	ditto
130	d 11.3.1822	483	Brockhamlea not Brookhamlea
135	Thakeham not Thakenham	487	add Cremated at Brighton
148	G23D not 23?	489	add w of D450
173	d 27.11.1829	498	1961 not 1962
192	Ae 55? not 41	502	add Cremated at Brighton
221	Parbrook not Padbrook	508	Ae 84 not 92
224	do bu 8.10.1844	509	Louise not Louisa
233	delete entry	519	Peter Dennis Vaughn MOREY d 19.12.1984
240	add D230 (Drover)	520	Margaret Mary WILLIAMS (Madge) 1896-1985 w of D512 G32F
246	Ae 66	521	Bernard Eric EVERSLED Ae 67 G14B
		522	Louisa Winifred WAIDE Ae 78 G15E

MONUMENTAL INSCRIPTIONS (G1A, 1B &c)

4C	add D348
5G	401 not 481
6G	1873 not 1878
6P	1838 not 1833
8A	1883 & 77 not 1887 & 7
8C	add Elizabeth
9E	add: 'Received but Yesterday the Gift of Breath Ordered tomorrow to return to death'
9L	1836 not 1830
10C	60 not 68
10D	Stephen not Stephe 1814 not 1811

MONUMENTAL INSCRIPTIONS (Continued)

- 11A TOWES not Towse
 11B delete entry
 11C amend first two lines to read: James Knight who died
 Nov 4th 1808 Agd 45 years Ann wife of James Knight who died
 at Ryde in the Isle of Wight Decr 3rd 1839 Agd 83 years
 11J delete FS: SK 1853
 11L James Knight died Nov 16 1811 Mary died 1818
 12C 41 not 49 1779 was probably an inscription error
 12E 75 not 59
 13D Parental not Parential add 'Details from FE'
 13E January not June
 14B 82 not 83
 14C John not Richard Streele not Street
 14E departed not depated
 14G 1765 not 1785
 14N 225 not 255
 15C 28th March not 2nd
 15D DHS: Madeline D Beard D516
 Born 28th Dec 1905 Died 29th Jan 1980
 15E HS: In Loving memory of John James Evershed D492
 younger son of William Evershed (of Tedfold)
 who died 13th August 1958 aged 89 years
 Dorothy M Evershed (nee Bevan) who died D506
 16th November 1970 aged 91 years
 And their daughter L Winifred Waide who died D522
 31st October 1986 aged 78 years
 15M HS: Sacred to the memory of William Potter Evershed D464
 elder son of William & Caroline Evershed
 Born 24th March 1867 Died 24th March 1944
 15P 103 not 105
 16N July 13th not 18th
 17A delete last line
 17B 332 not 403
 17D March 1st not May
 17F 1885 not 1855 98th not 90th
 17G 8th 1857 not 18th 1847
 17J PISELY not Pisley
 18B Shackelford not Shack
 18D Years not yars
 18F full inscription reads:
 In loving memory of Frank Carter 'Greyfriars' Stamford who
 passed away May 22nd 1934 Aged 62 years. Engineer & Inventor.
 'For when the One Great Scorer comes Go write against your name
 He writes not that you won or lost But how you played the game'
 18H 476 not 259
 19B 1970 not 1940 John Turner not James Turner
 19C 1980 & 73 not 1960 & 88
 20A June not July
 20B interred not intered add D185
 20E 82 not 80 years
 22A 1862 not 1863
 23A 365 not 276 276 not 365 73 not 59 years
 23D Charlotte not Charlottee 148 not 209
 24B 1808 not 1801
 24D Buried in High Street Chapel Yard Portsmouth
 24E delete brackets & ?

MONUMENTAL INSCRIPTIONS (Continued)

- 26A add D432
 28A 1884 not 1880
 28C Fewhurst not Ewhurst
 28E Tauranga not Tauranga
 28J 6th not 16th
 29F to God not o God
 30B June 9th not Jan 5th
 31H 24th April not Aug 25th
 31J Edward not Howard Louisa not Louise
 32D Jonathan not John
 32F Headstone reads: In Memory of
 Frank WILLIAMS 1895-1975 and D512
 Margaret Mary WILLIAMS (Madge) 1896-1985 D520
 'Rest in Peace'
 32H 491 not 273 1957 not 1857
 33A May 28th 1954 not 26th 1951
 33B 84 not 85
 33D no headstone yet D519
 - space for grave
 33E HS: Here rest the ashes of Kitty Haines D503
 4th October 1967 and her beloved husband
 Sandy 26th June 1969 D504
 33H 85 not 55

GRAVEYARD PLAN Page 54

Revise as indicated:

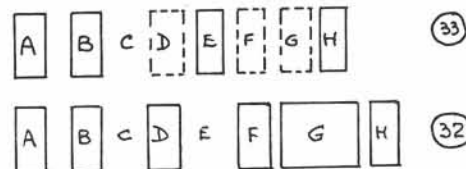

GRAVEYARD PLAN Page 55

Revise as indicated:

